

Wildlife and Countryside Act 1981
Applications for the addition to the Definitive Map
and Statement of Five Public Footpaths at Banks
Enclosed Marsh, North Meols, West Lancashire

Photographs taken June 2014

Application 804-526

Route 1

Shown between points A-B-C-D-E on Committee plan 2

Point A from Georges Lane

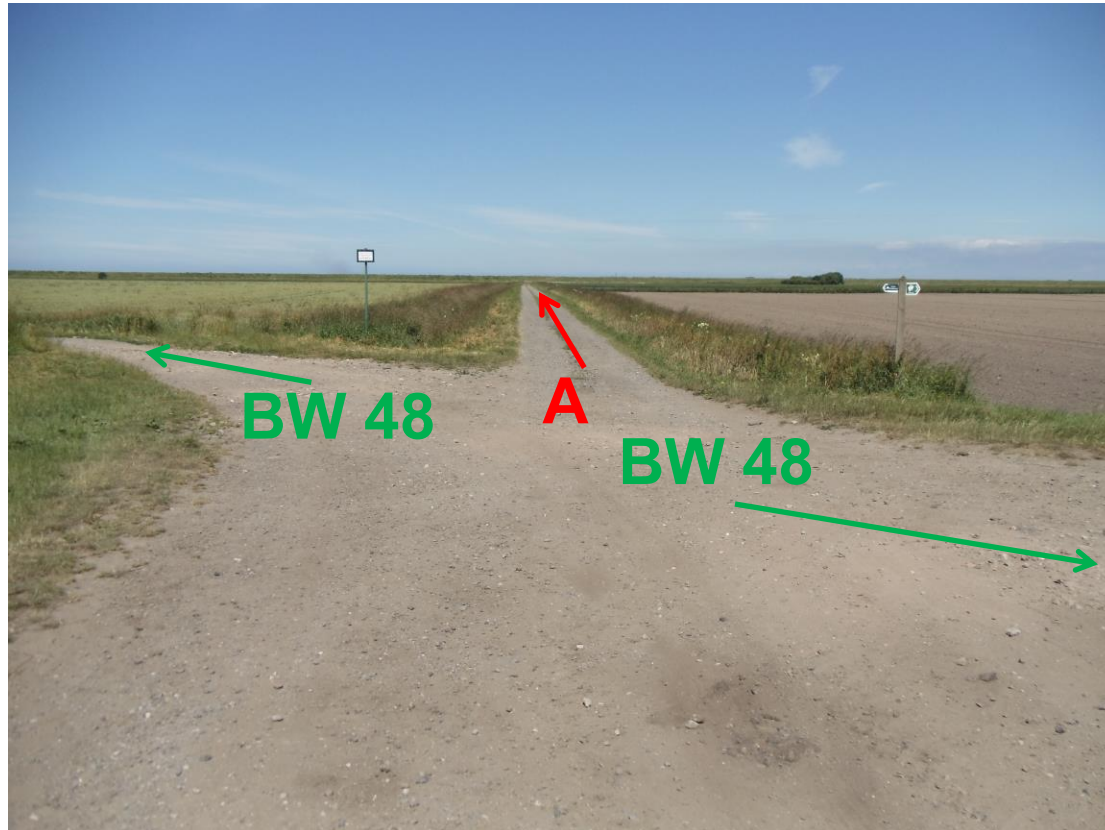

Sign adjacent to route close to point A



Application route between points **A-B-C**



Application route between points **B** - **C** - **D**



Application route between points C - D



Application route approaching point D



Gate and stile at point **D** with Environment Agency sign positioned to left of stile



Historical and documentary evidence

Route 1

Plan contained in letter sent by John Bentham to the Scarisbrick Estate Office 1895

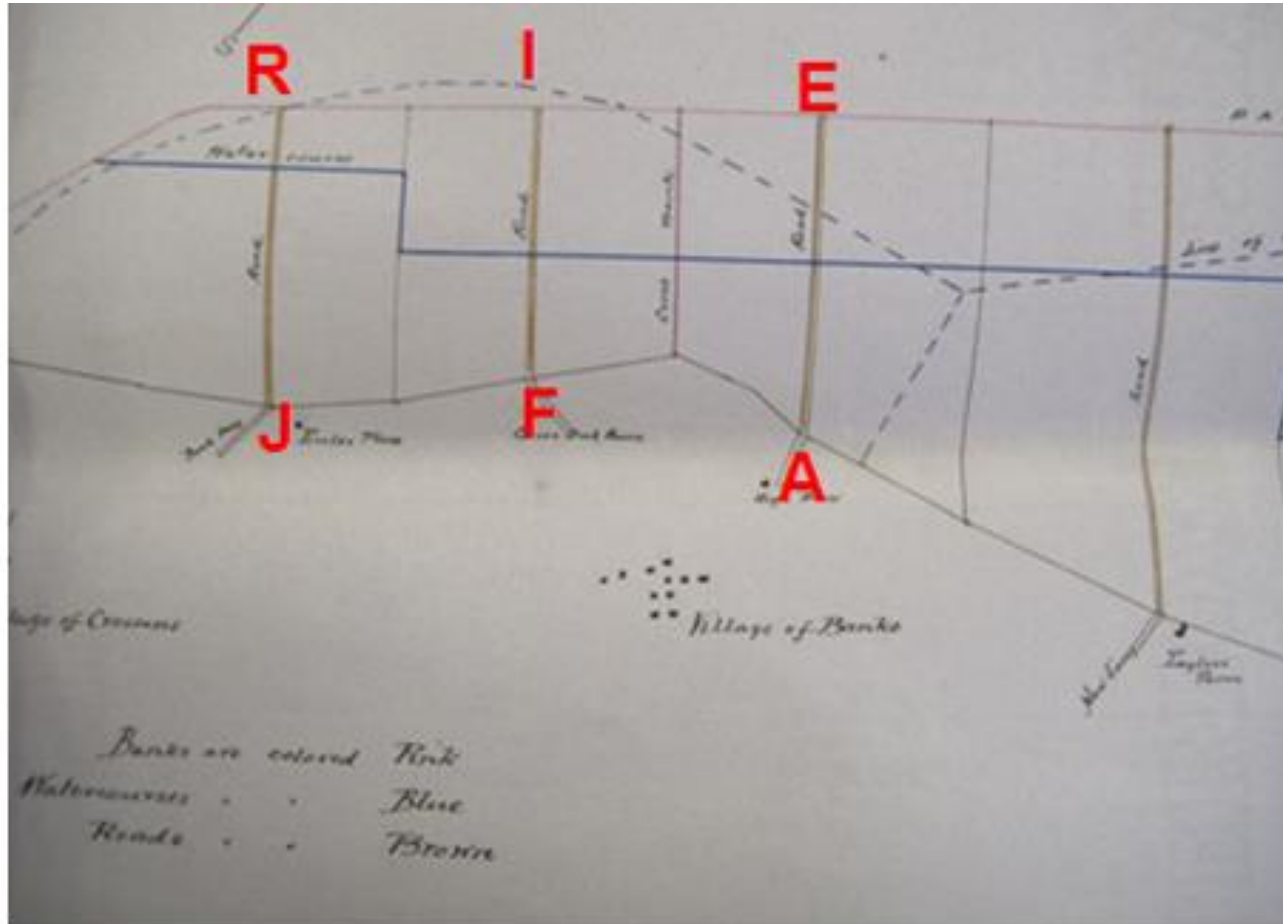

25 inch OS map published 1910-1911

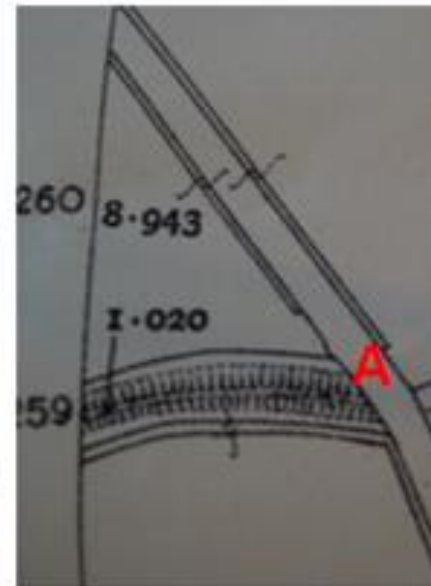

1910 Finance Act

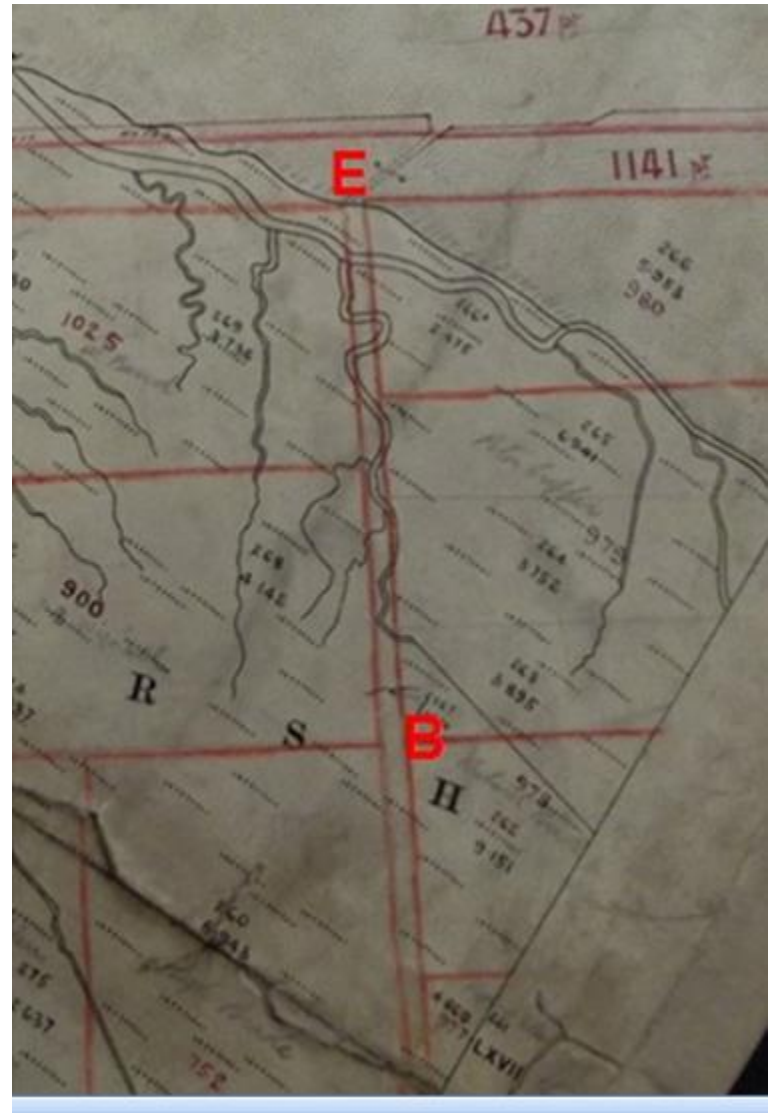



LCC Highway Records



The Authentic Map Directory of South Lancashire circa 1934

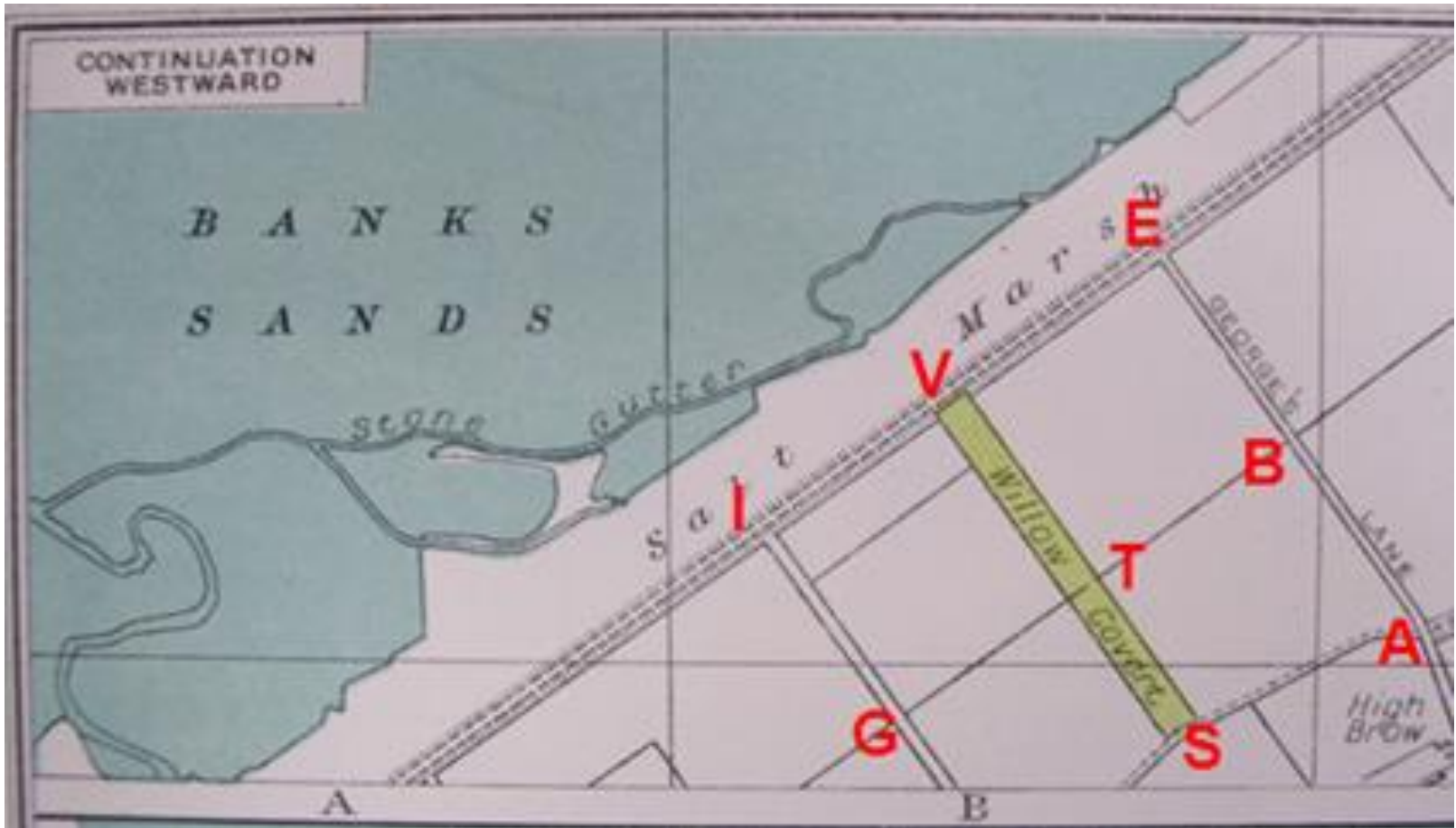

North Meols Parish Survey Map



Draft Map



Application 804-527

Route 2

Shown between Points F-G-H-I on Committee plan 2

Point F

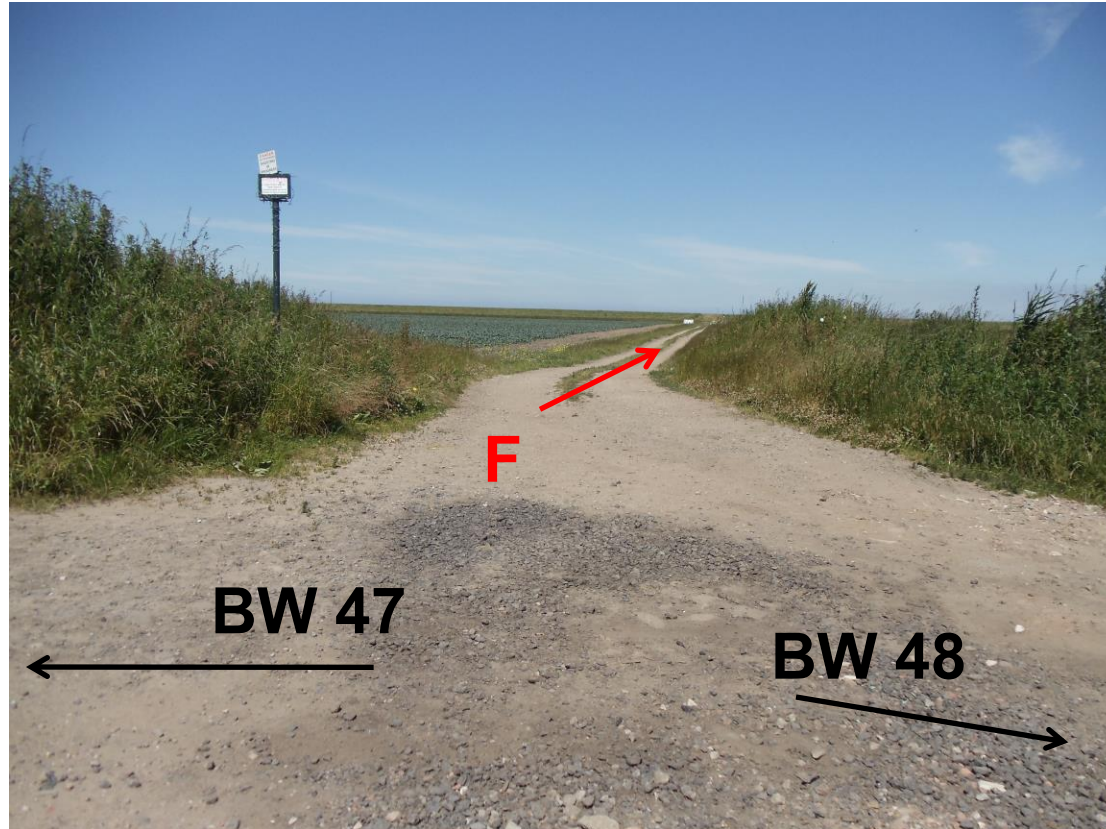

From point **F** looking towards point **G** and point **H**



Between point **G** and point **H**



Approaching point H



Gate at point H



Stile north east of point H



Sign located close to stile



Point I on landward side of sea embankment

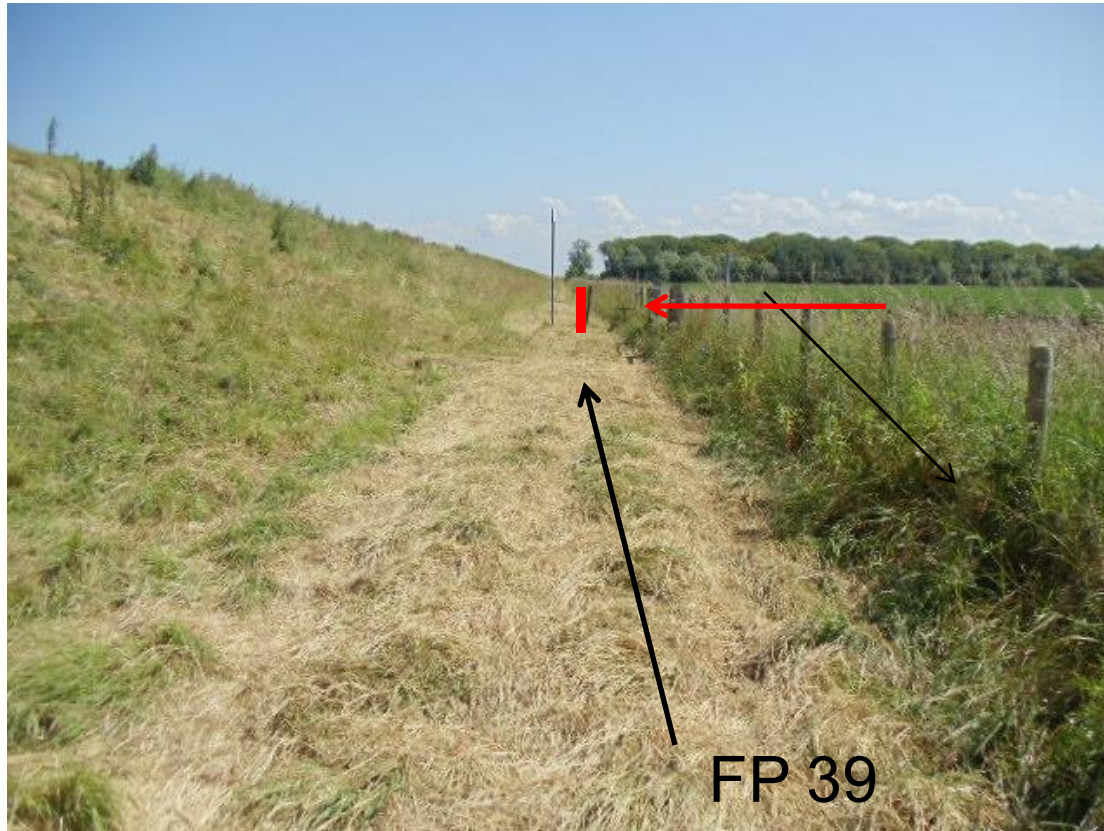

Historical and documentary evidence

Route 2

25 inch OS Map published 1910 - 1911

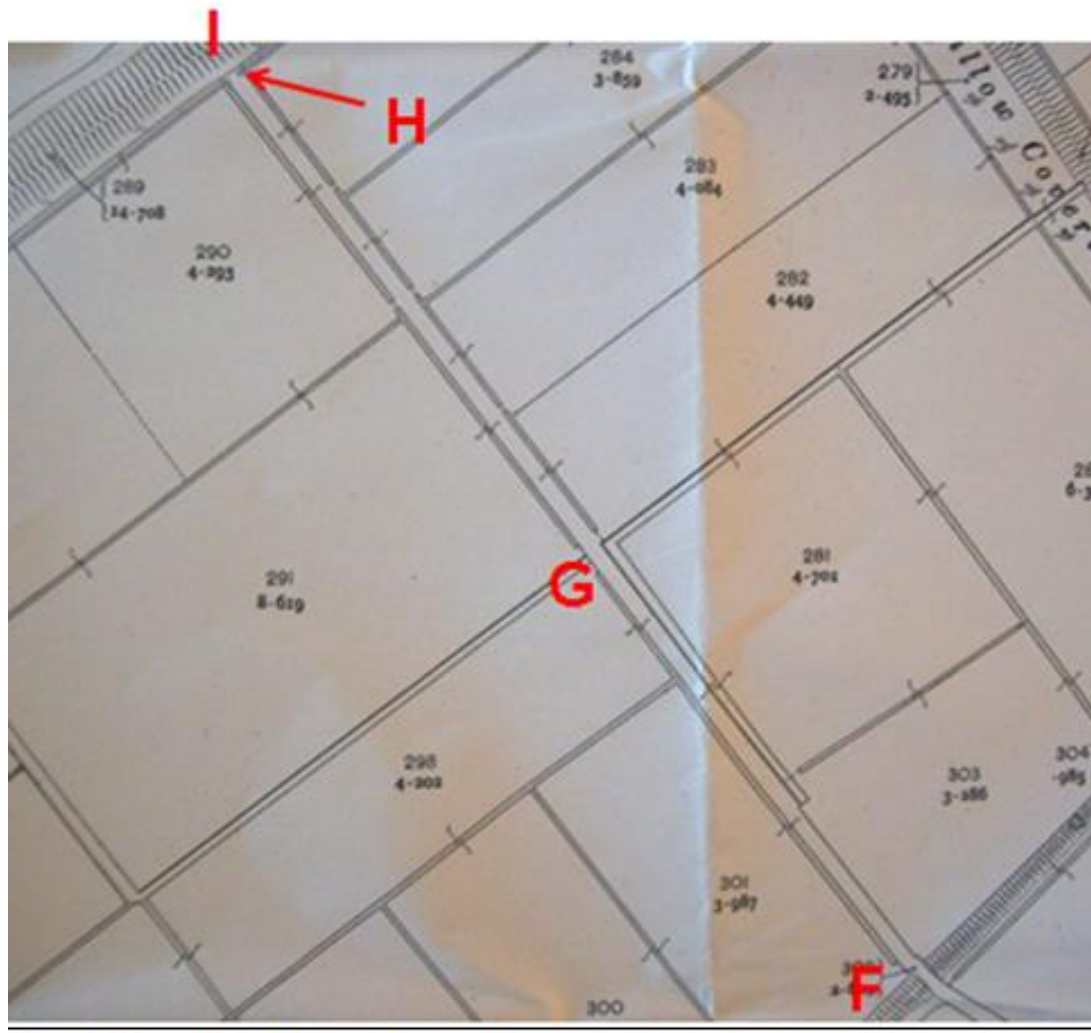



1910 Finance Act



LCC Highways Records



The Authentic Map Directory of South Lancashire circa 1934

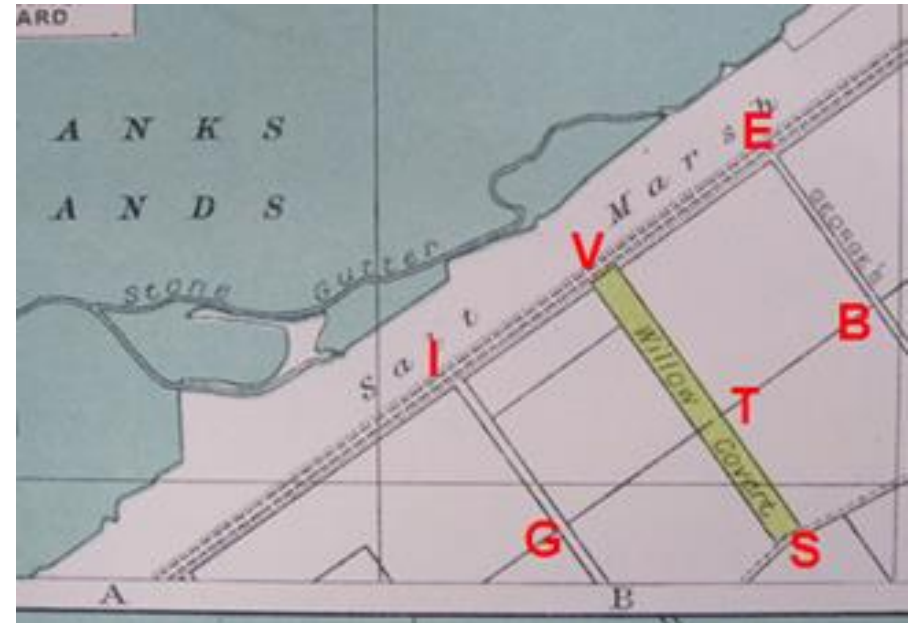

North Meols Parish Survey Map



Draft Map

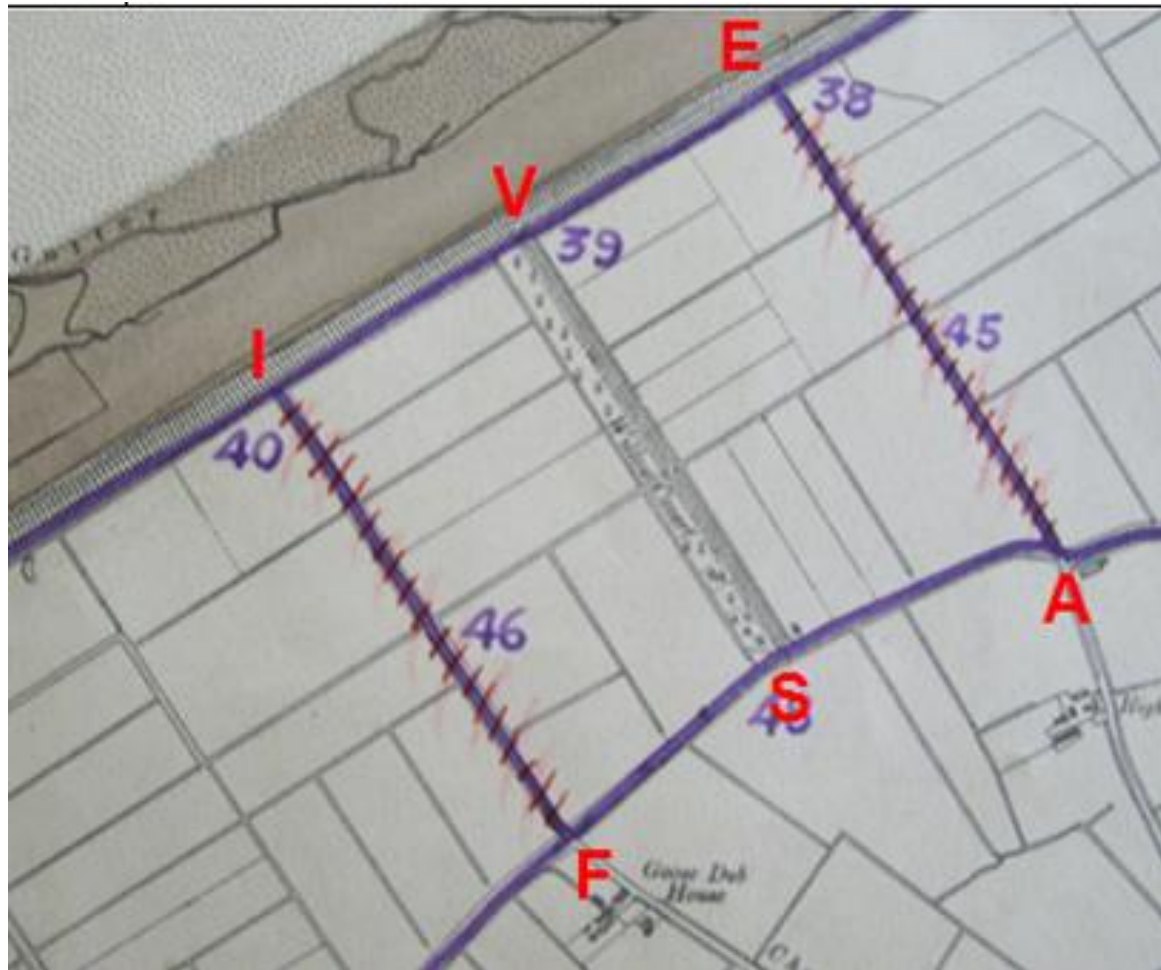

Application 804-528

Route 3

Points J-K-L-M-N-O on Committee plan 1

Point J on Bridleway 47 North Meols

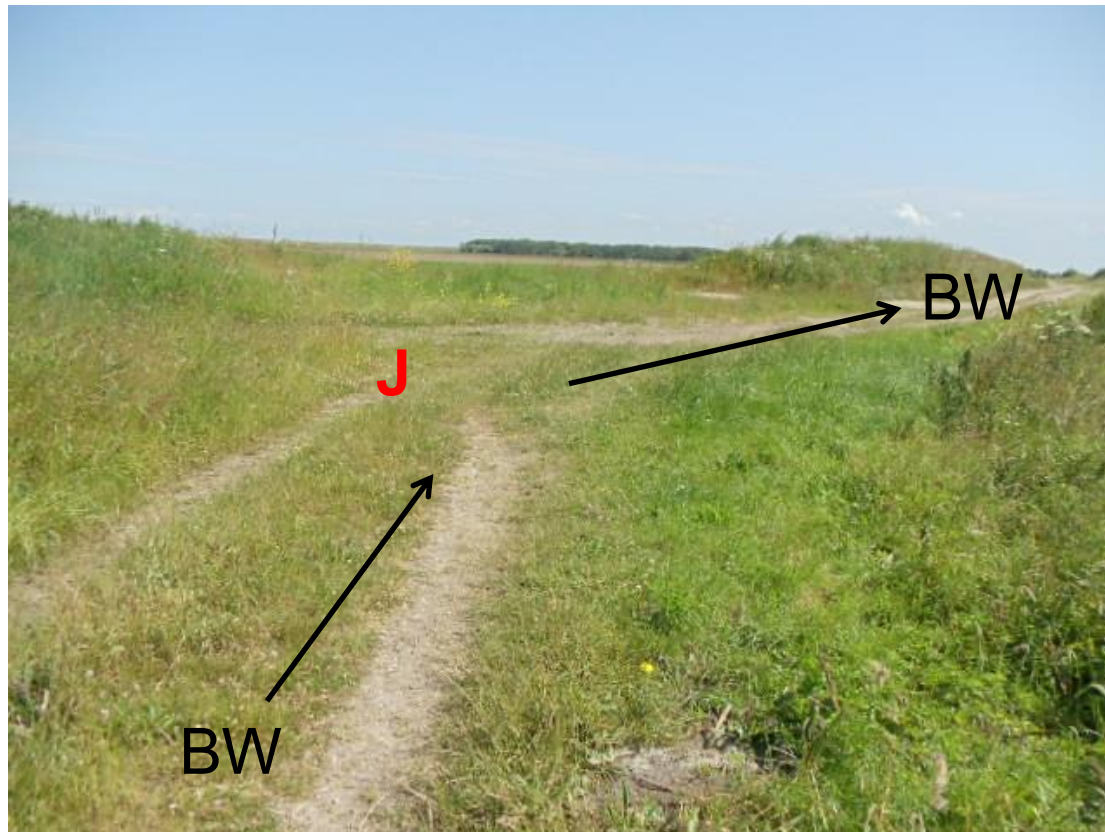

Route between point J and point K



From point **K** looking along the route towards point **L**



Route between point **K** and point **L**



Point L



Between point **L** and point **M**



Between point **L** and point **M**



Approaching point M



Point M



Between point **M** and point **N**



Approaching point N



Point N





Signage at point N

Looking across ditch and fence to point O



Historical and documentary evidence

Route 3

First Edition 6 inch OS Map published 1848

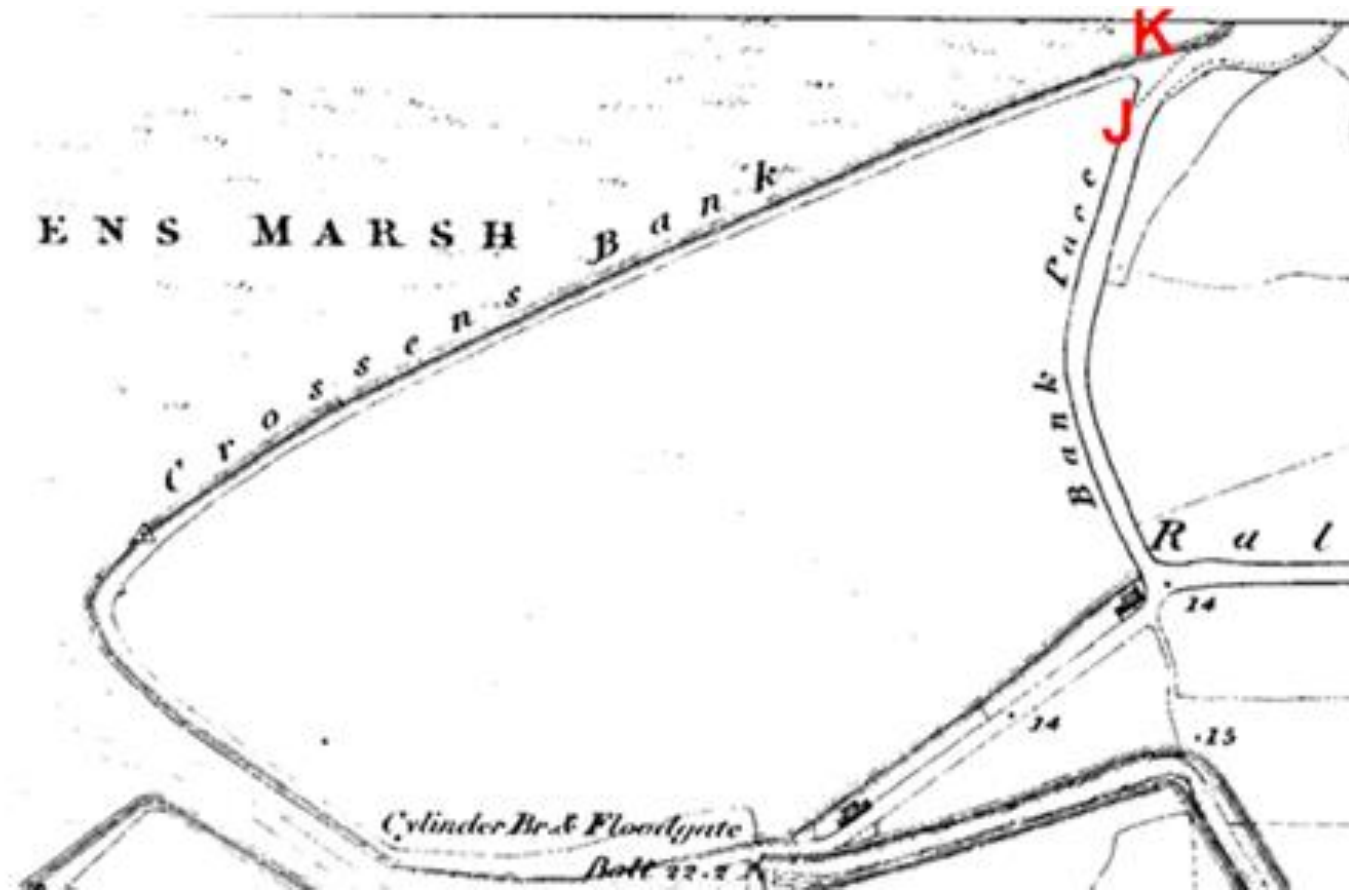

25 inch OS map published 1892

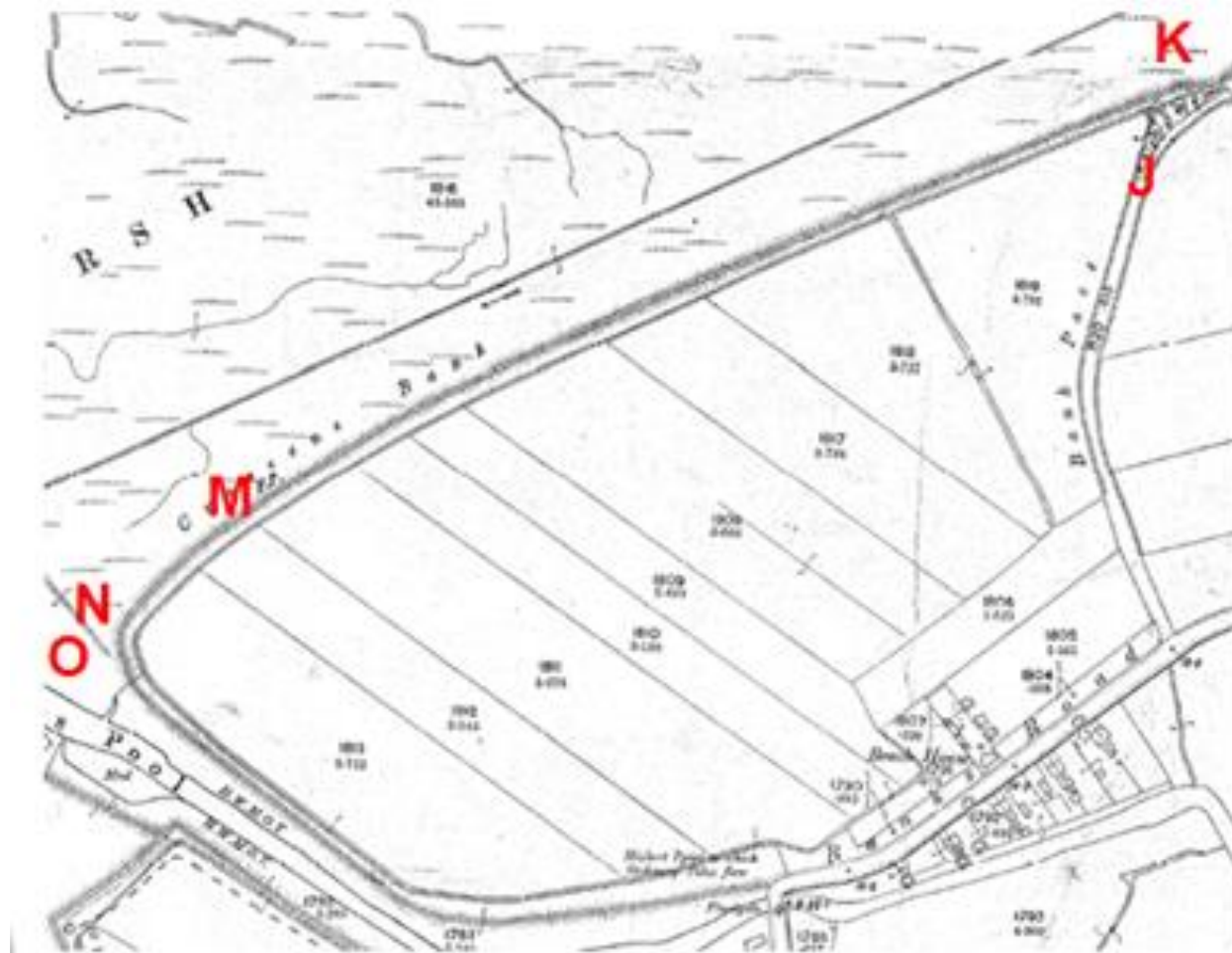

1:10,000 OS map published 1983



1940 aerial photograph

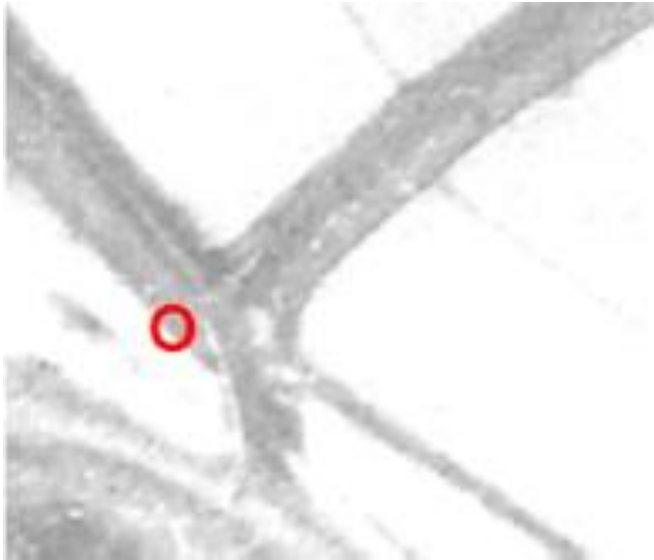

1963 aerial photograph



1988 aerial photograph



1910 Finance Act

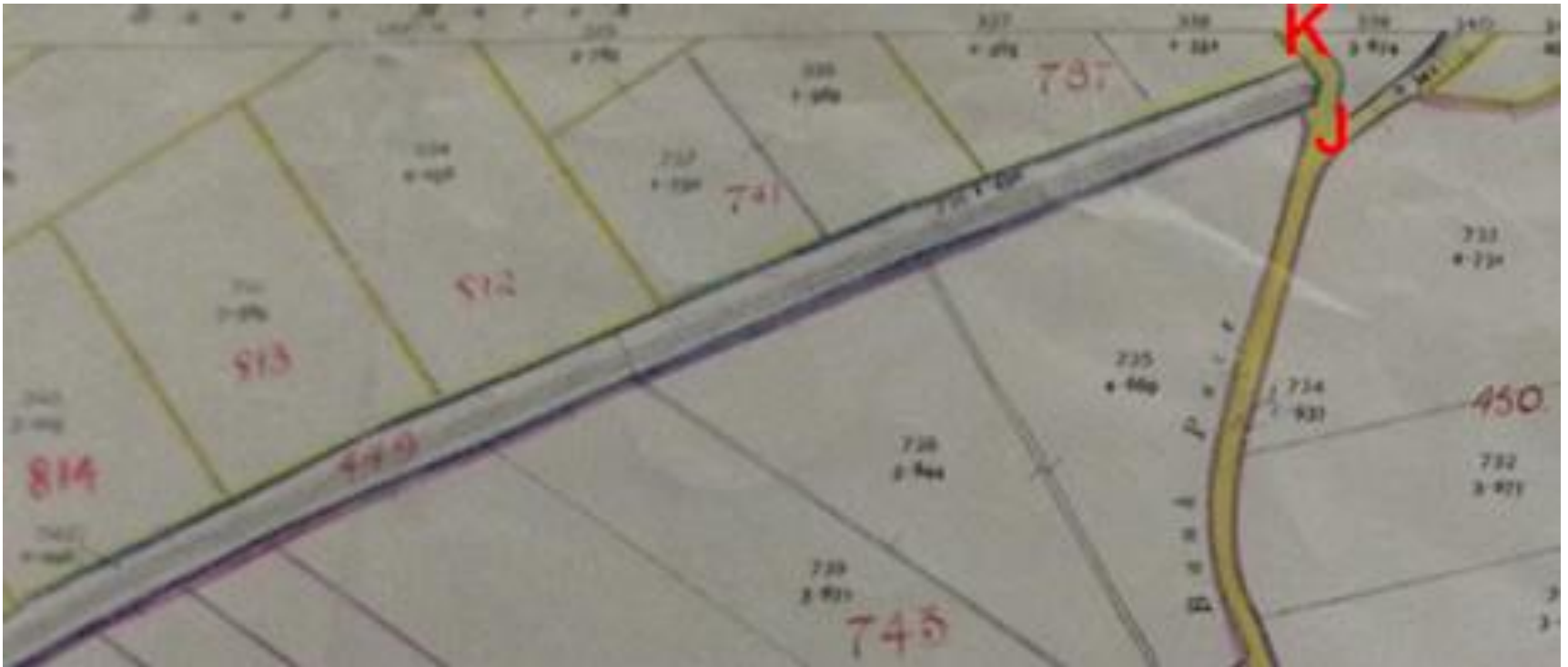

The Authentic Map Directory of South Lancashire circa 1934



Application 804-530

Route 4

Points J-K-P-Q-R on Committee plan 1

Point J – Point K

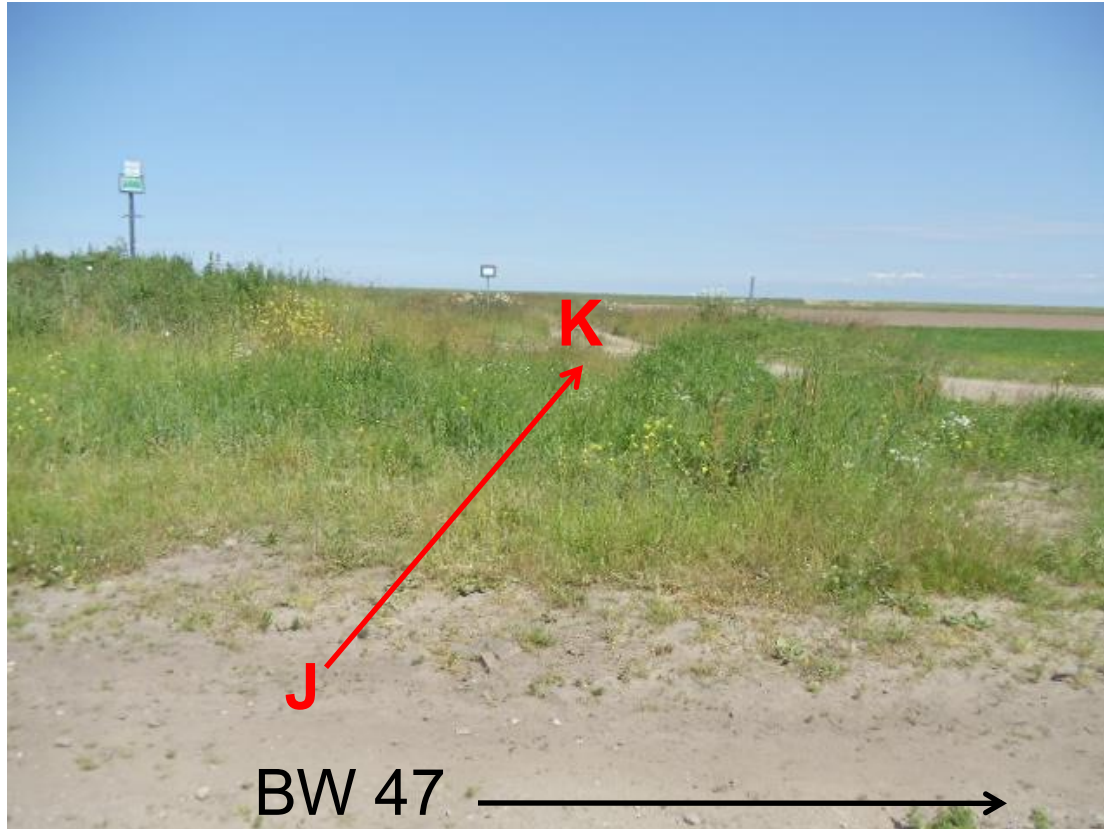

Point **K** looking towards point **P**



Sign adjacent to point K



Route between point **K** and point **P**



Point **P** looking towards point **Q**



Between point **P** and point **Q**



Approaching point Q



Remains of stile on south east (left) side of gate and signage on north east (right) side of gate at point Q



Historical and documentary evidence

Route 4

Plan attached to a letter sent by Mr John Bentham to the Scarisbrick Estate Office in 1895

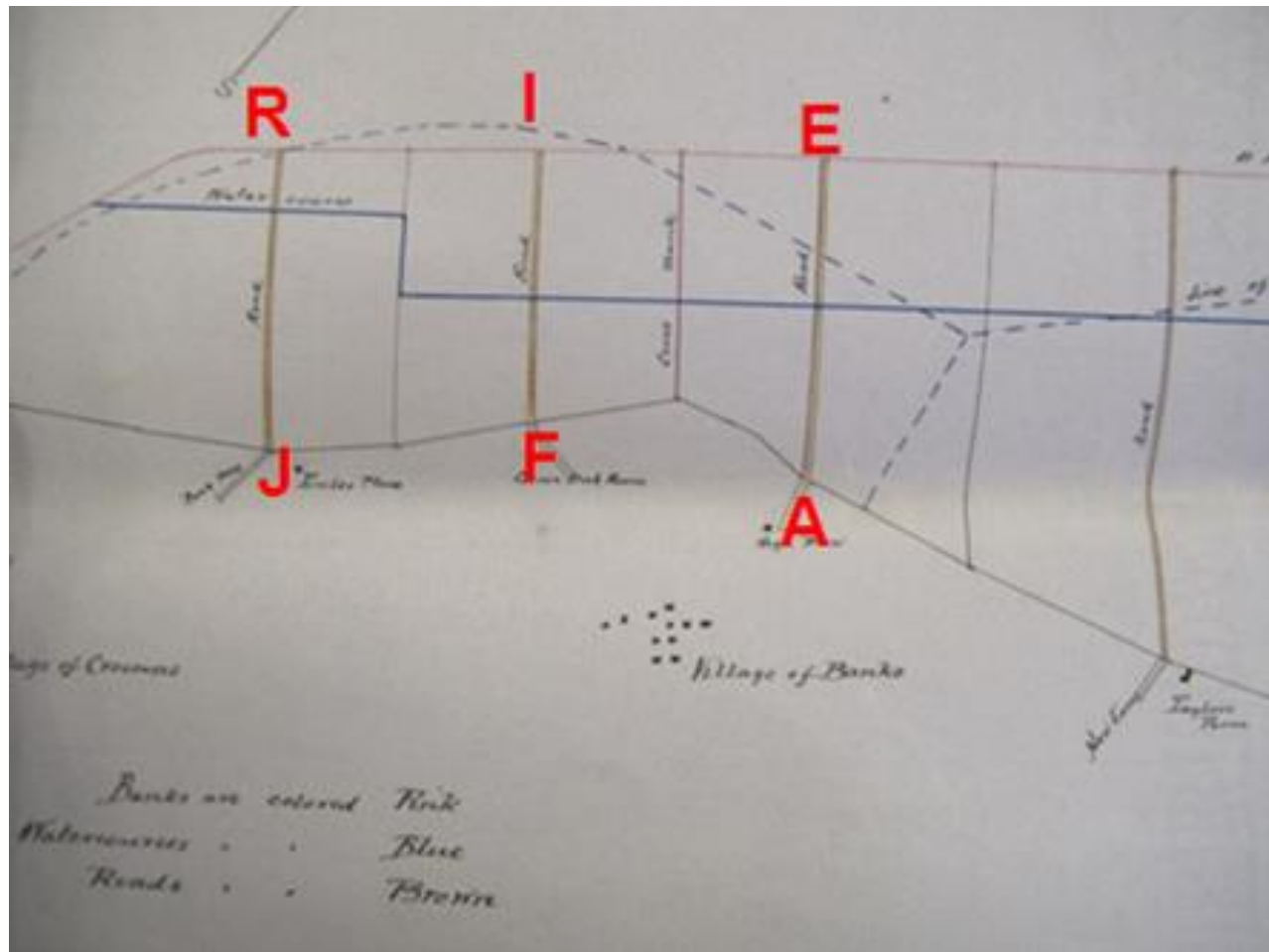

25 inch OS Map published 1910 - 1911





1910 Finance Act

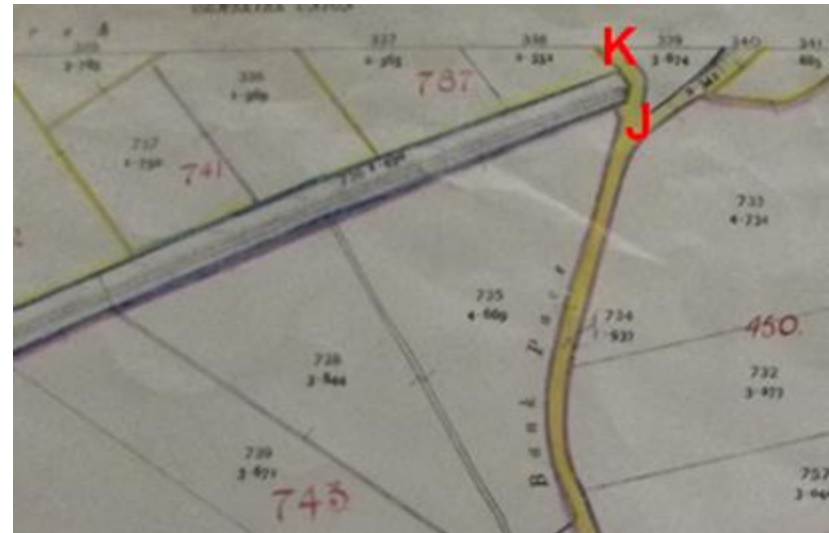

The Authentic Map Directory of South Lancashire circa 1934

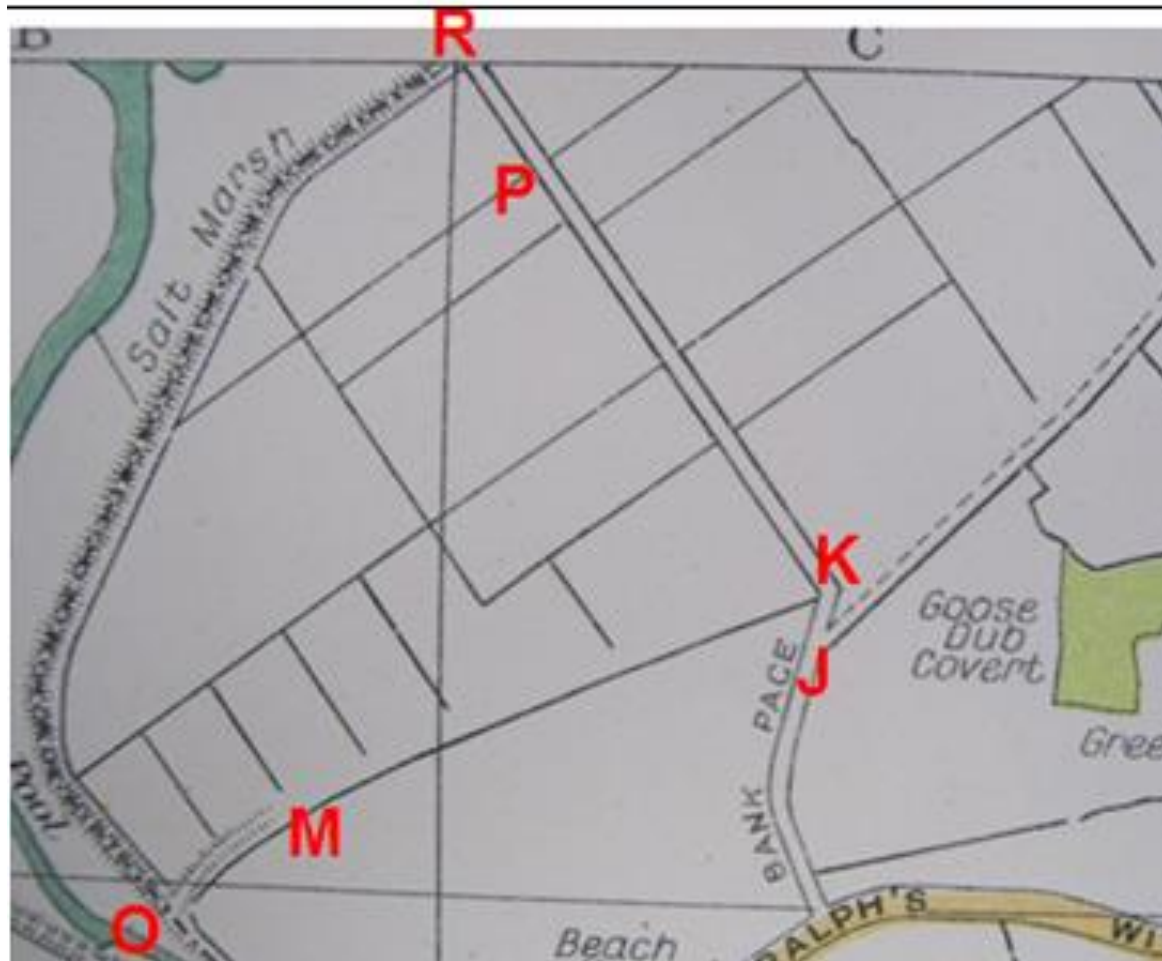

Application 804-531

Route 5

Points S-T-U-V on Committee Plan 2

Point S





Signage close
to point **S**

Signage close to point S



Between point **S** and point **T**



Between point **S** and point **T**



Point T



Point T



Between point **T** and point **U**



Approaching point U





Point U



Ditch at point **U** looking
towards point **V**

Point V



Historical and documentary evidence

Route 5

Plan attached to letter sent by Mr John Bentham to the Scarisbrick Estate Office 1895

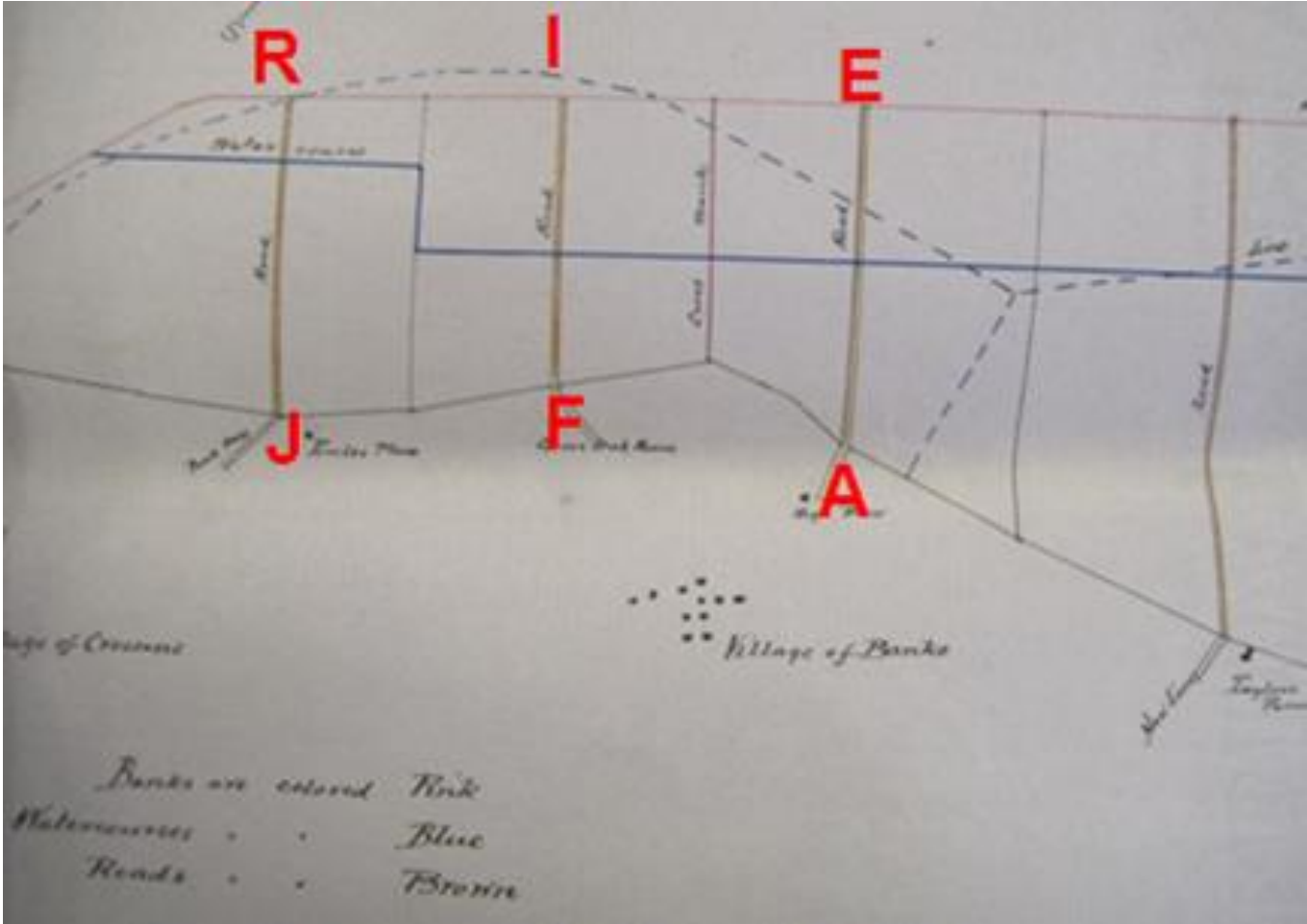

25 inch OS map published 1910 - 1911

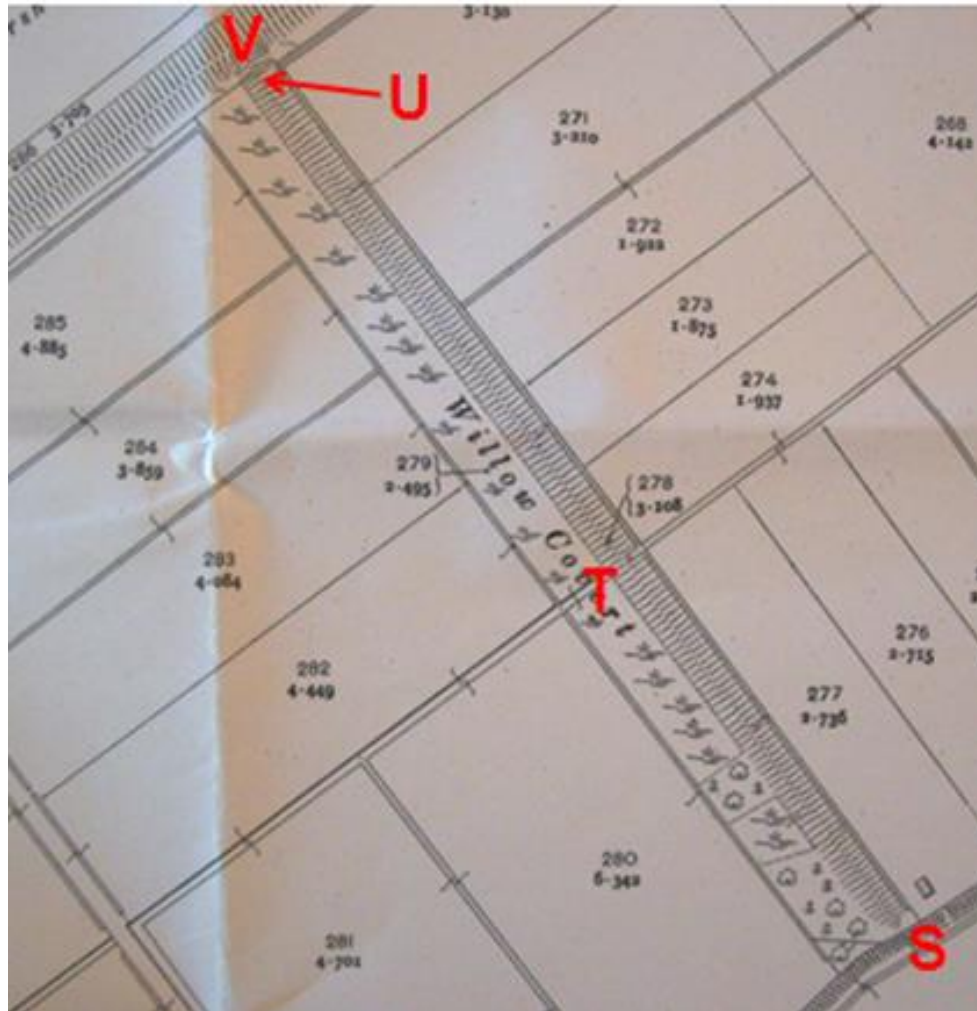



1910 Finance Act

The Authentic Map Directory of South Lancashire circa 1934

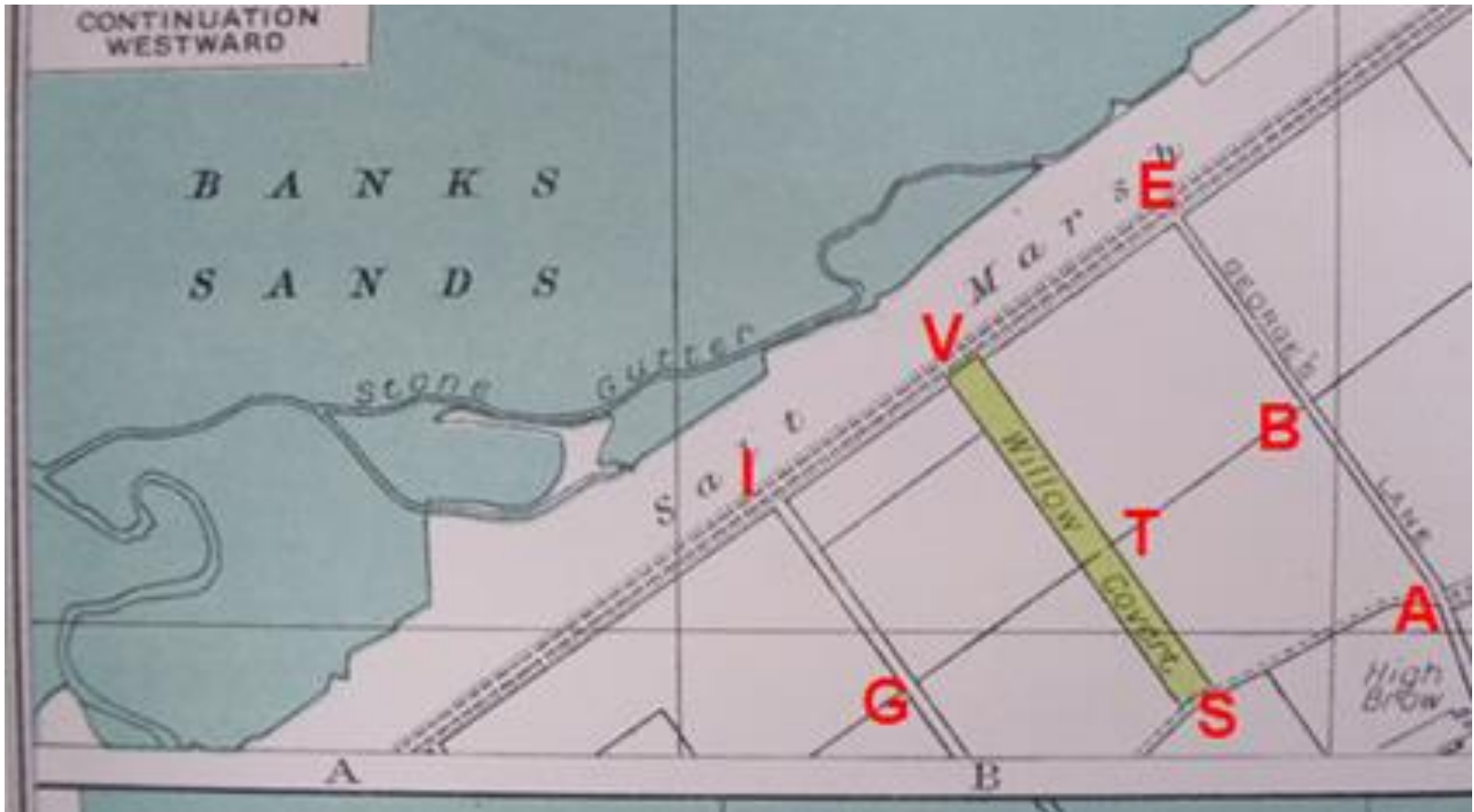

Wildlife and Countryside Act 1981
Applications for the addition to the Definitive Map
and Statement of Five Public Footpaths at Banks
Enclosed Marsh, North Meols, West Lancashire

Photographs taken June 2014

Application 804-526

Route 1

Shown between points A-B-C-D-E on Committee plan 2

Point A from Georges Lane

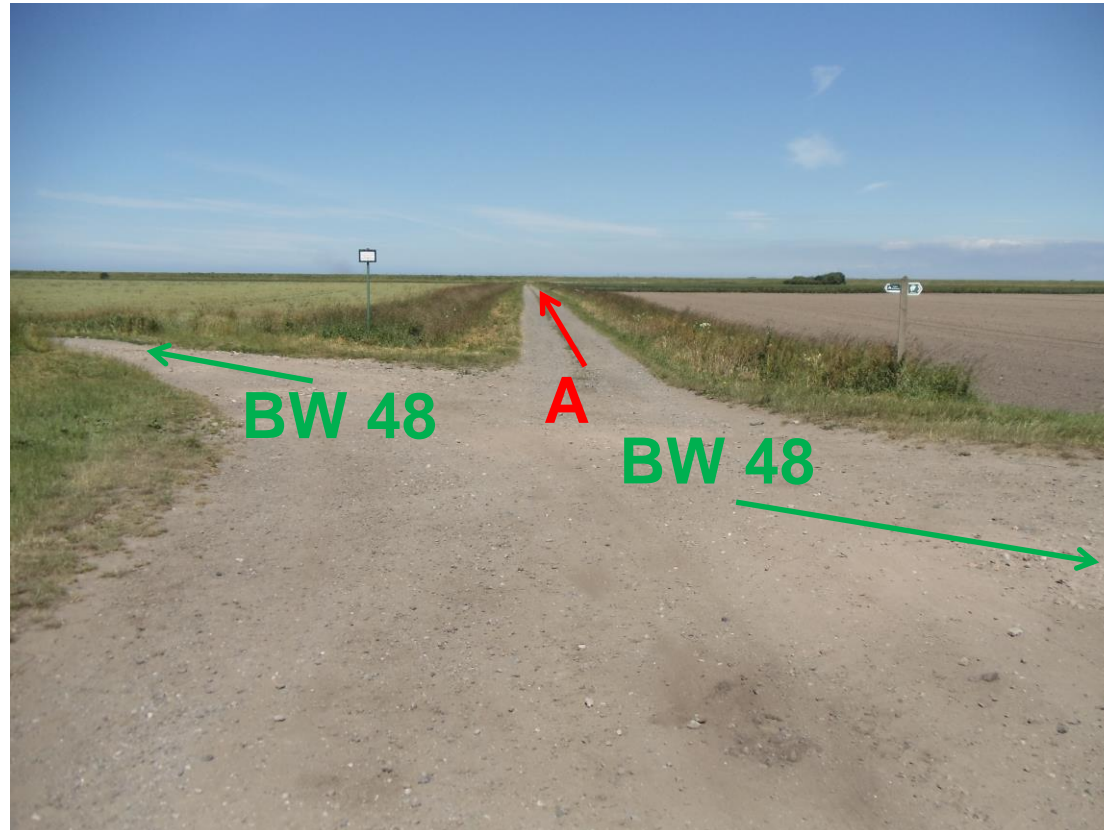

Sign adjacent to route close to point A



Application route between points A-B-C



Application route between points **B - C - D**



Application route between points C - D



Application route approaching point D



Gate and stile at point **D** with Environment Agency sign positioned to left of stile



Application 804-527

Route 2

Shown between Points F-G-H-I on Committee plan 2

Point F

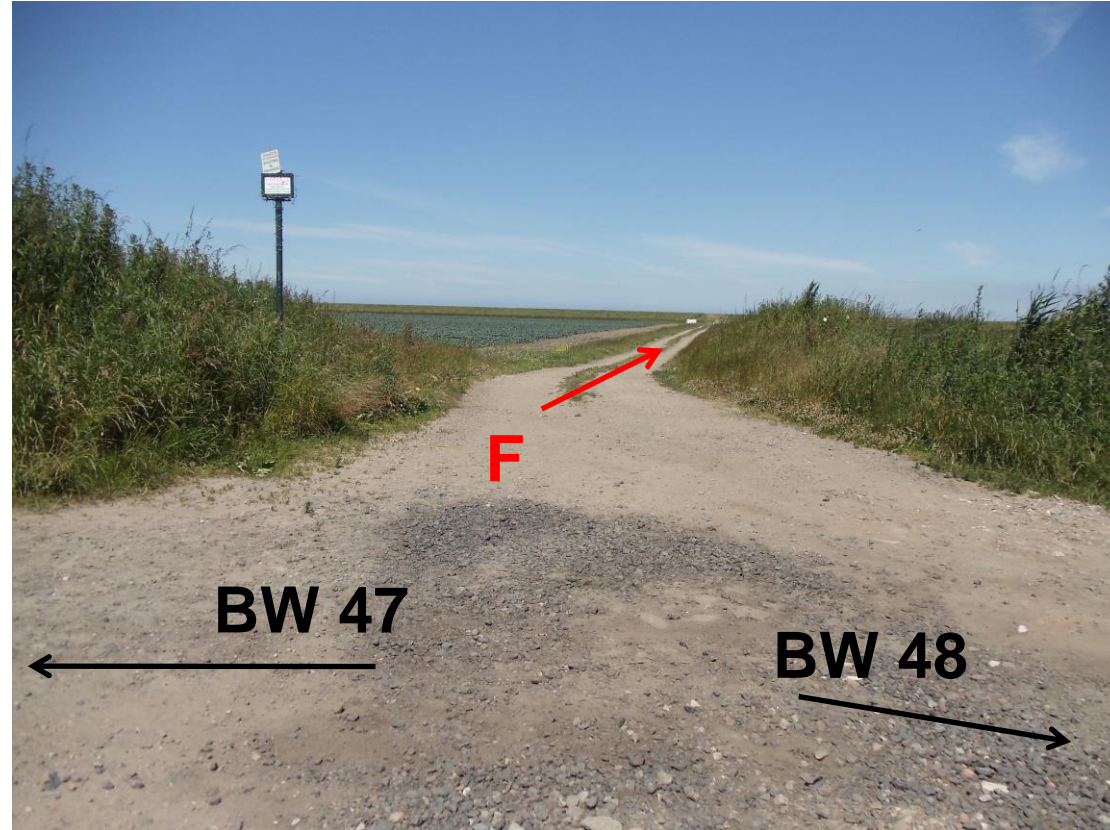

From point **F** looking towards point **G** and point **H**



Between point **G** and point **H**



Approaching point H



Gate at point H



Stile north east of point H



Sign located close to stile



Point I on landward side of sea embankment

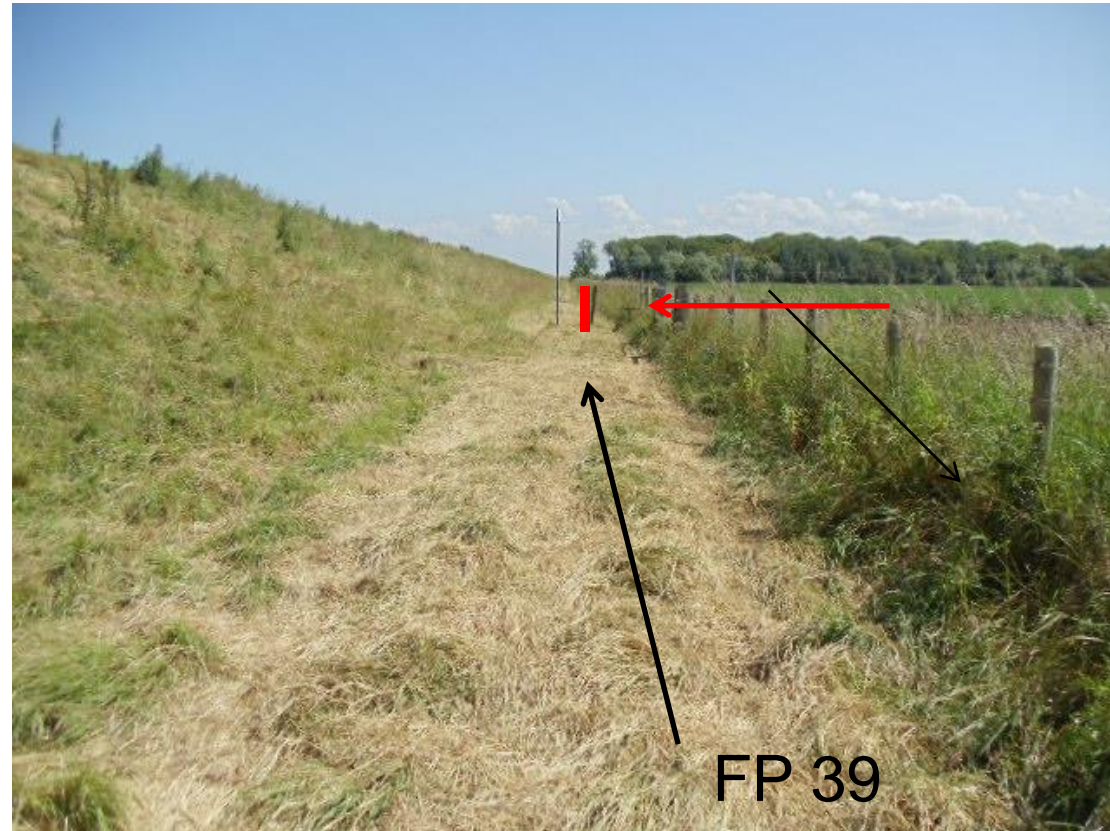

Application 804-528

Route 3

Points J-K-L-M-N-O on Committee plan 1

Point J on Bridleway 47 North Meols

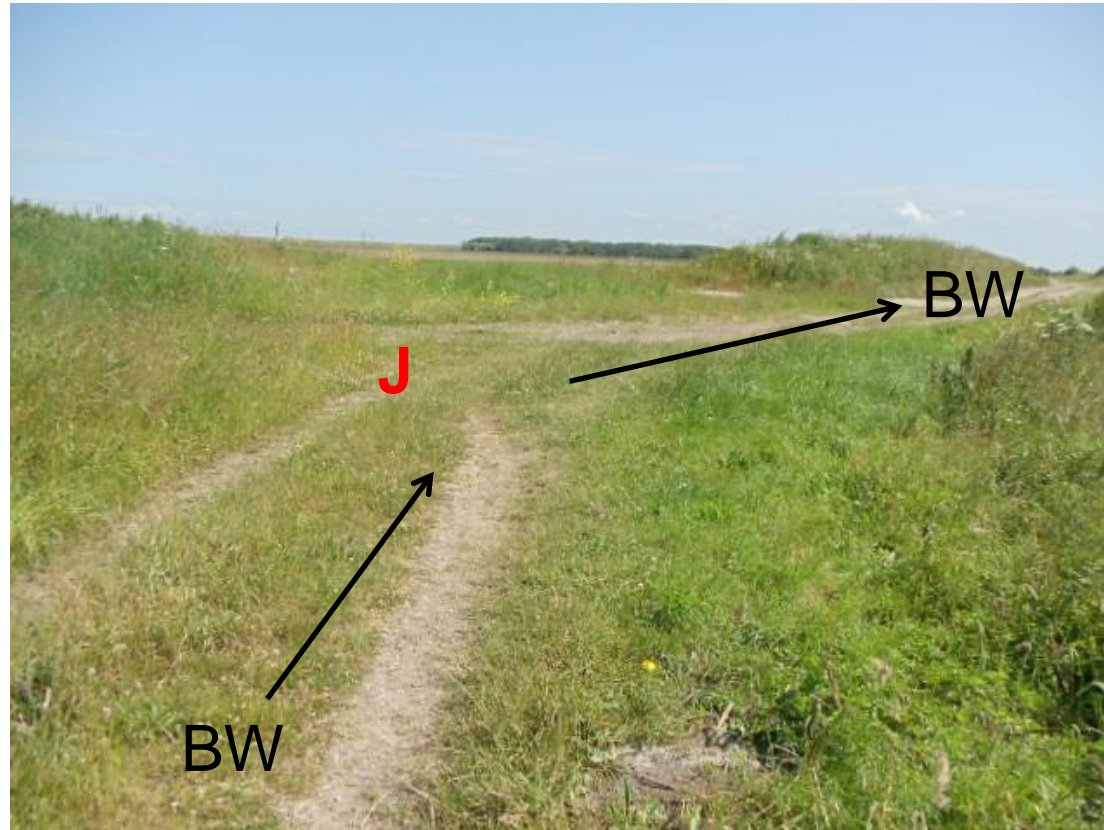

Route between point J and point K



From point **K** looking along the route towards point **L**



Route between point **K** and point **L**



Point L



Between point **L** and point **M**



Between point **L** and point **M**



Approaching point **M**



Point M



Between point **M** and point **N**



Approaching point N



Point N





Signage at point N

Looking across ditch and fence to point O



Application 804-530

Route 4

Points J-K-P-Q-R on Committee plan 1

Point J – Point K

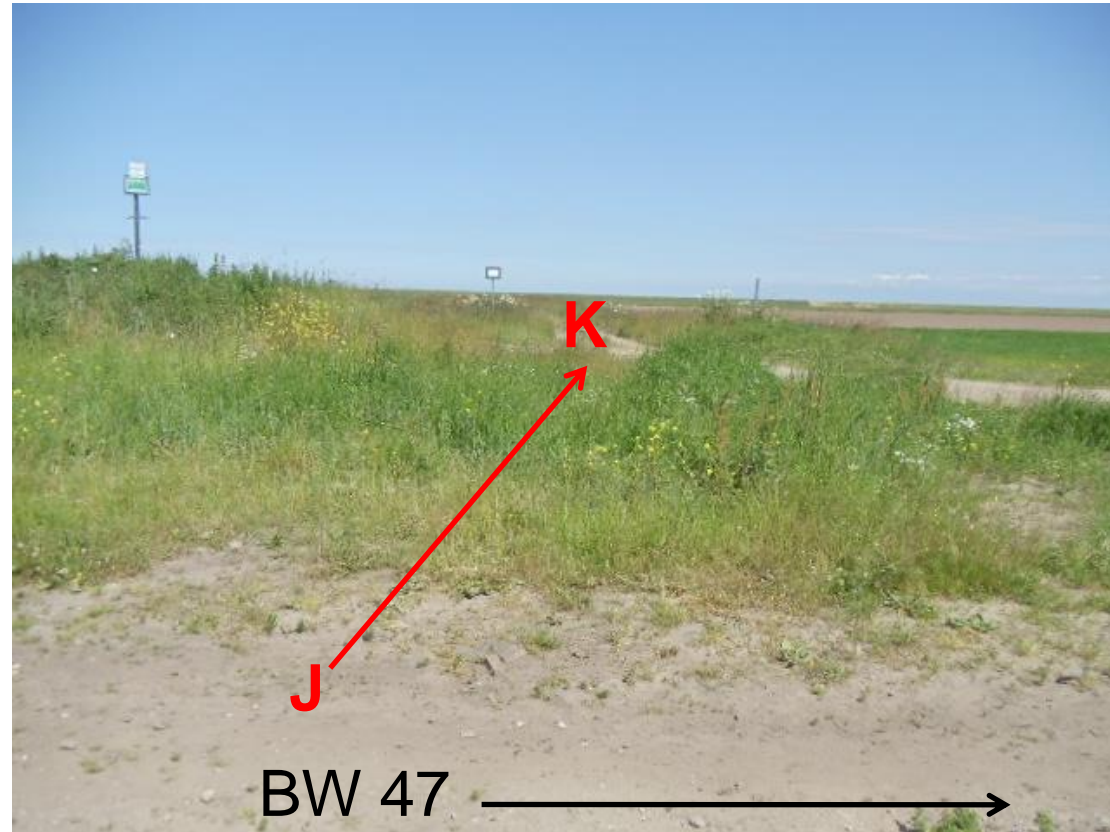

Point **K** looking towards point **P**



Sign adjacent to point K



Route between point **K** and point **P**



Point **P** looking towards point **Q**



Between point **P** and point **Q**



Approaching point Q



Remains of stile on south east (left) side of gate and signage on north east (right) side of gate at point Q



Application 804-531

Route 5

Points S-T-U-V on Committee Plan 2

Point S





Signage close
to point **S**

Signage close to point S



Between point **S** and point **T**



Between point **S** and point **T**



Point T



Point T



Between point **T** and point **U**



Approaching point U





Point U



Ditch at point **U** looking
towards point **V**

Point V

