

Z:\projects\2562 DD Gorsey Lane Mawdsley-Lancashire (Jones Homes)\CAD\Croft Drawings\2562-TRO-03 Rev E.dwg

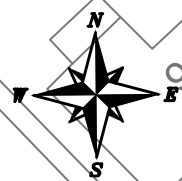
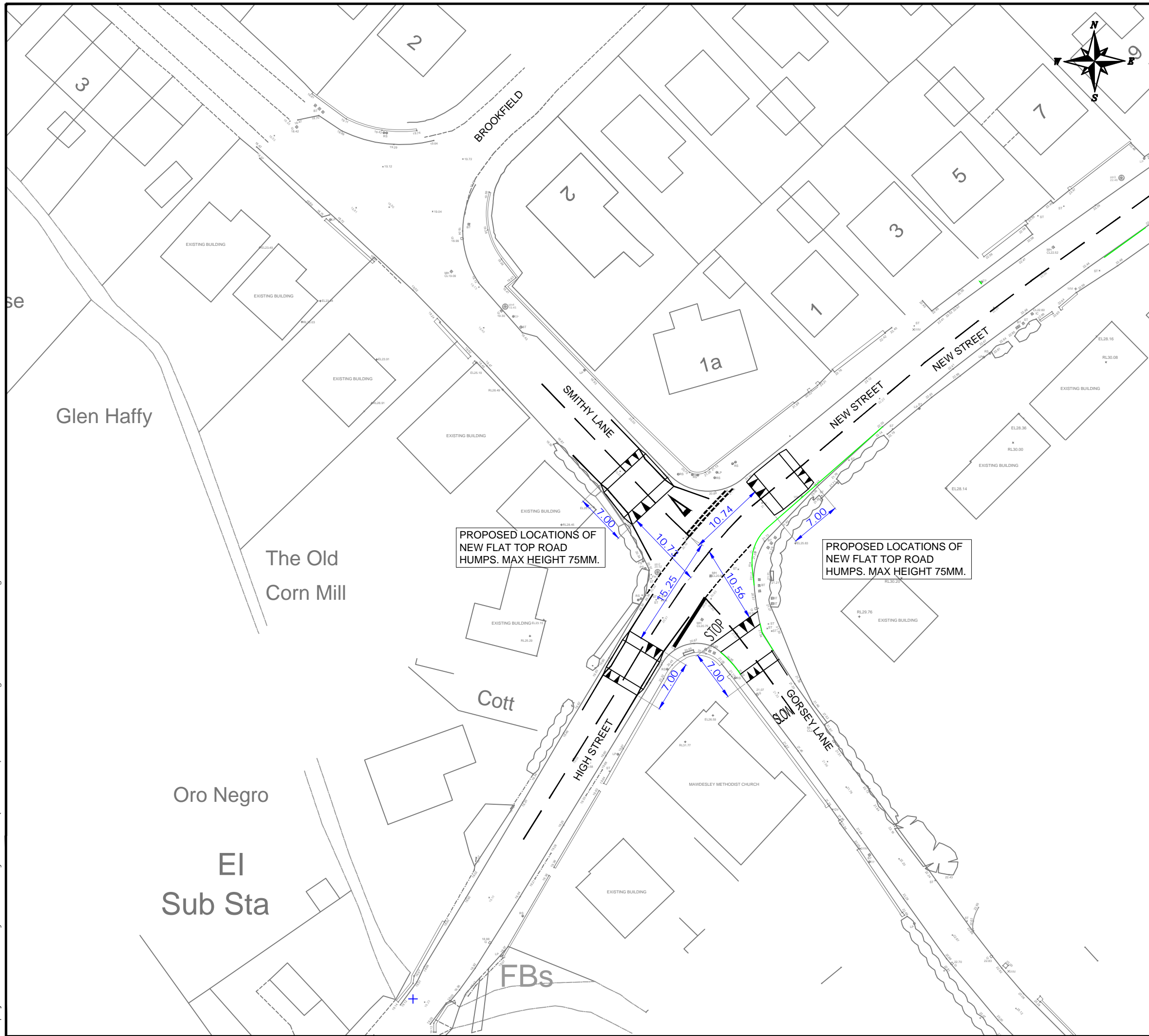

NOTES

THIS IS NOT A CONSTRUCTION DRAWING AND IS FOR INDICATIVE PURPOSES ONLY.
THE DRAWING WILL BE SUBJECT TO CHANGE FOLLOWING LOCAL AUTHORITY REVIEW AND CONFIRMATION OF PUBLIC HIGHWAY AND THIRD PARTY LAND BOUNDARIES.

- DENOTES NEW KERBS
- EXISTING ROAD MARKINGS
- PROPOSED ROAD MARKINGS

E	UPDATED FOLLOWING LCC COMMENTS	HL	JC	SEP 23
D	UPDATED FOLLOWING LCC COMMENTS	HL	JC	JUL 23
C	UPDATED FOLLOWING LCC COMMENTS	LB	JC	JUL 23
B	UPDATED FOLLOWING LCC COMMENTS	LB	JC	JUN 23
A	LAYOUT UPDATED	LB	JC	MAY 23

REV	DETAILS	DRAWN	CHECKED	DATE
-----	---------	-------	---------	------

CLIENT:	JONES HOMES
---------	-------------

PROJECT:	GORSEY LANE, MAWDESLEY, ORMSKIRK
----------	-------------------------------------

DRAWING TITLE:	S278 TRO PLAN
----------------	---------------

SCALES:	1:500 @ A3
---------	------------

DRAWN:	LB	CHECKED:	JC	DATE:	FEB 23
--------	----	----------	----	-------	--------

Eddisons 340 Deansgate Manchester M3 4LY Email: info@croftts.co.uk Tel: 0161 837 7380 Web: www.eddisons.com/services/transport-planning

DRAWING NUMBER:	2562-TRO-03	REVISION:	E
-----------------	-------------	-----------	---

