

General Notes

All site dimensions shall be verified by the Contractor on site prior to commencing any works.

Do not scale from this drawing.

Only work to written dimensions.

This drawing is the property of Fletcher-Rae (UK) Limited (t/a Fletcher-Rae) and copyright is reserved by them. The drawing is not to be copied or disclosed by or to any unauthorised persons without the prior written consent of Fletcher-Rae (UK) Limited.

PLANNING

--- Development Boundary

Concrete finish

Tarmac finish

Block paving on main entrances

SCHEDULE OF AREAS

UNIT 1		
WAREHOUSE	1,672 sqm	18,000 sqft
~10% OFFICES	167 sqm	1,800 sqft
TOTAL	1,839 sqm	19,800 sqft
UNIT 2		
WAREHOUSE	1,394 sqm	15,000 sqft
~10% OFFICES	139 sqm	1,500 sqft
TOTAL	1,533 sqm	16,500 sqft
UNIT 3		
WAREHOUSE	232 sqm	2,500 sqft
~20% MEZZANINE	46 sqm	500 sqft
TOTAL	279 sqm	3,000 sqft
UNIT 4		
WAREHOUSE	232 sqm	2,500 sqft
~20% MEZZANINE	46 sqm	500 sqft
TOTAL	279 sqm	3,000 sqft
UNIT 5		
WAREHOUSE	465 sqm	5,000 sqft
~15% MEZZANINE	70 sqm	750 sqft
TOTAL	534 sqm	5,750 sqft
UNIT 6		
WAREHOUSE	465 sqm	5,000 sqft
~15% MEZZANINE	70 sqm	750 sqft
TOTAL	534 sqm	5,750 sqft
UNIT 7		
WAREHOUSE	232 sqm	2,500 sqft
~20% MEZZANINE	46 sqm	500 sqft
TOTAL	279 sqm	3,000 sqft
UNIT 8		
WAREHOUSE	232 sqm	2,500 sqft
~20% MEZZANINE	46 sqm	500 sqft
TOTAL	279 sqm	3,000 sqft

OVERALL TOTAL 5,556 sqm 59,800 sqft

SITE AREA 13,517 sqm 3.40 Acres

DENSITY 41.1 %

Revision

Scale

Status

Drawn by

Date

Client

Lancashire County Developments Ltd

Project

Lancashire Business Park, Leyland

Drawing Description

Proposed Site Plan

Drawing No. 19019_PL103

Rev. /

fletcher-rae
Architects | Master Planners | Designers

Hill Quays, 5 Jordan Street, Manchester, M15 4PY

t +44 (0)161 242 1140
f +44 (0)161 242 1141
w www.fletcher-rae.com
e info@fletcher-rae.com

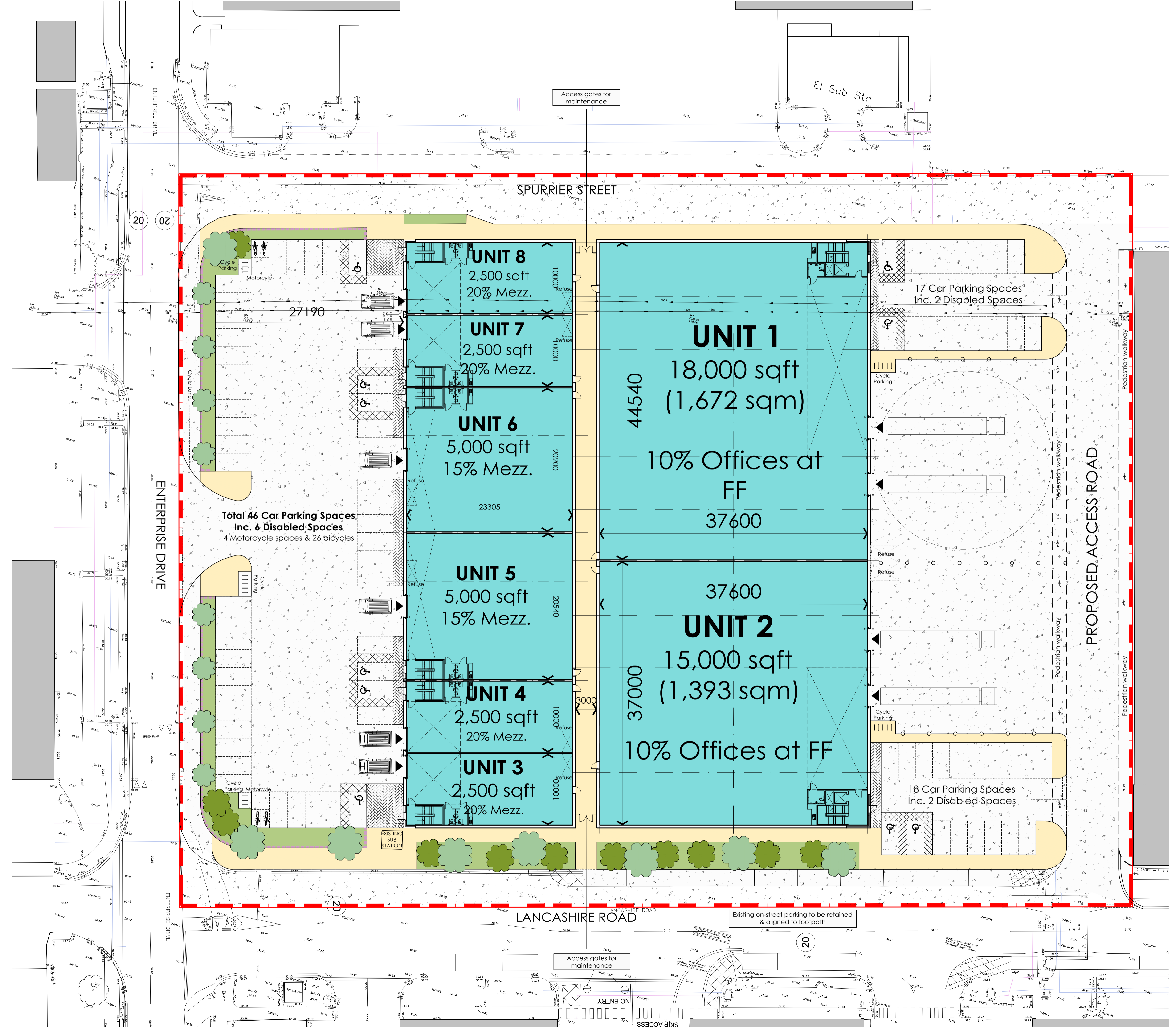
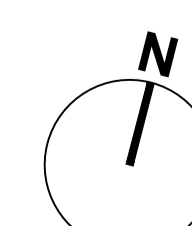

DRAFT