

**NOTICE OF PROPOSAL**  
**ROAD TRAFFIC REGULATION ACT 1984**  
**LANCASHIRE COUNTY COUNCIL**  
**(ACCESS ROAD TO NORTH BEACH CAR PARK AND**  
**TODMORDEN ROAD, LYTHAM ST ANNES, FYLDE**  
**BOROUGH) (PRIORITY CROSSINGS)**

**NOTICE IS HEREBY GIVEN** that Lancashire County Council propose to make the above priority crossings under Section 23 of the **Road Traffic Regulation Act 1984**, as amended, the effect of which will be to introduce priority crossings in the following locations:

- a) Todmorden Road, Lytham St Annes, from a point 9.5 metres south west of its junction with the centreline of Clifton Drive North for a distance of 4.5 metres in a south westerly direction;
- b) Access Road to North Beach Car Park, Lytham St Annes, from a point 5 metres south west of its junction with the centreline of Clifton Drive North for a distance of 4 metres in a south westerly direction.

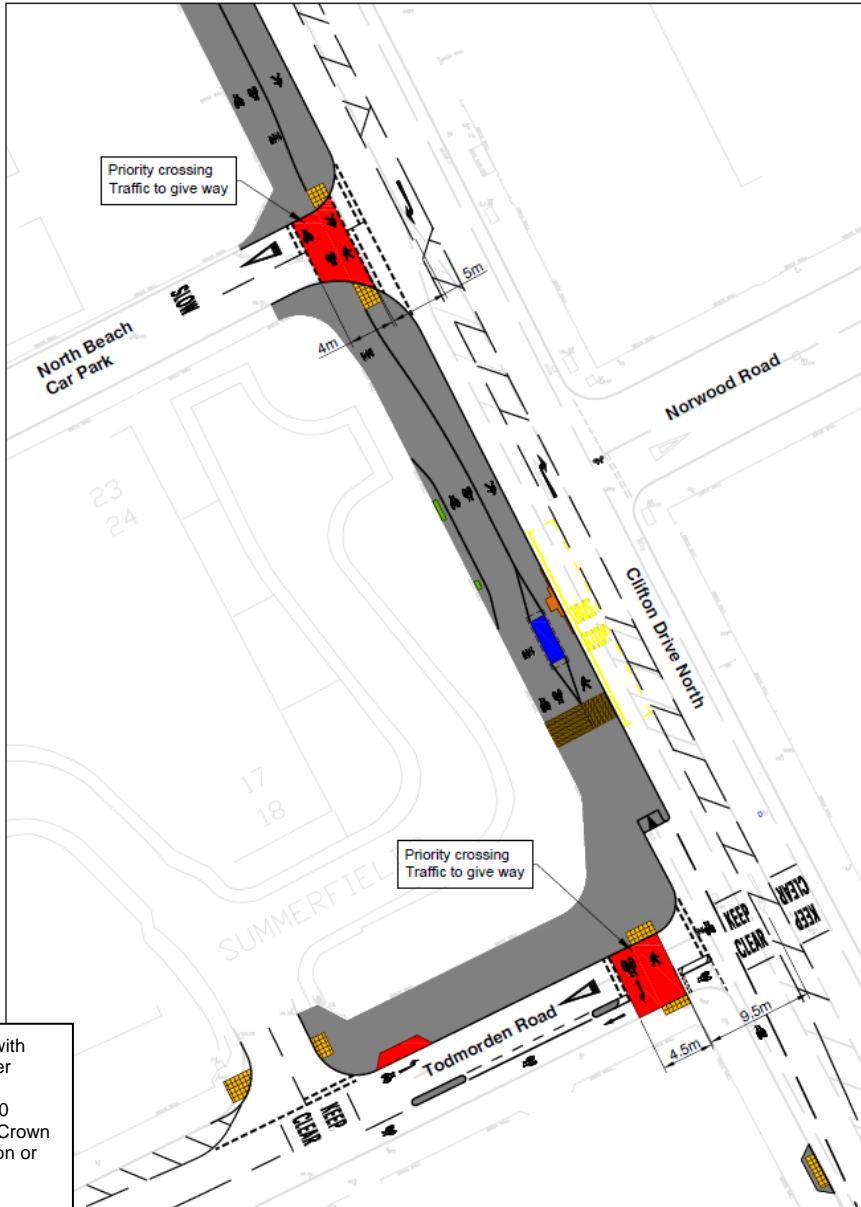

**Statement of Reasons**

Crossing facilities are proposed to facilitate the safe passage of cycles and pedestrians.

A copy of the relevant notice and plan indicating the location of the crossing may be inspected during normal office hours at the offices of the Fylde Borough Council, Town Hall, Lytham St Annes, FY8 1LW, and at the offices of The Director of Law and Governance, Lancashire County Council, County Hall, Fishergate, Preston, PR1 8XJ, and on Lancashire County Councils Website <http://www.lancashire.gov.uk/roads-parking-and-travel/roads/roadworks-and-traffic-regulation-orders/permanent.aspx>. Any representations or objections (specifying the grounds on which they are made) relating to the proposal must be made in writing and should be sent to The Director of Law and Governance, Lancashire County Council, P O Box 100, County Hall, Preston PR1 0LD or by e-mail to [tro-consultation@lancashire.gov.uk](mailto:tro-consultation@lancashire.gov.uk) quoting ref:LSG4/894.17385/AFR before 16 November 2023.

**Heloise MacAndrew, Director of Law and Governance**  
**19 October 2023**