

*Based on Ordnance Survey mapping with the permission of the Controller of Her Majesty's Stationery Office. © Crown copyright. Unauthorised reproduction infringes Crown copyright and may lead to prosecution or civil proceedings.
Lancashire County Council Licence No. LA100023320

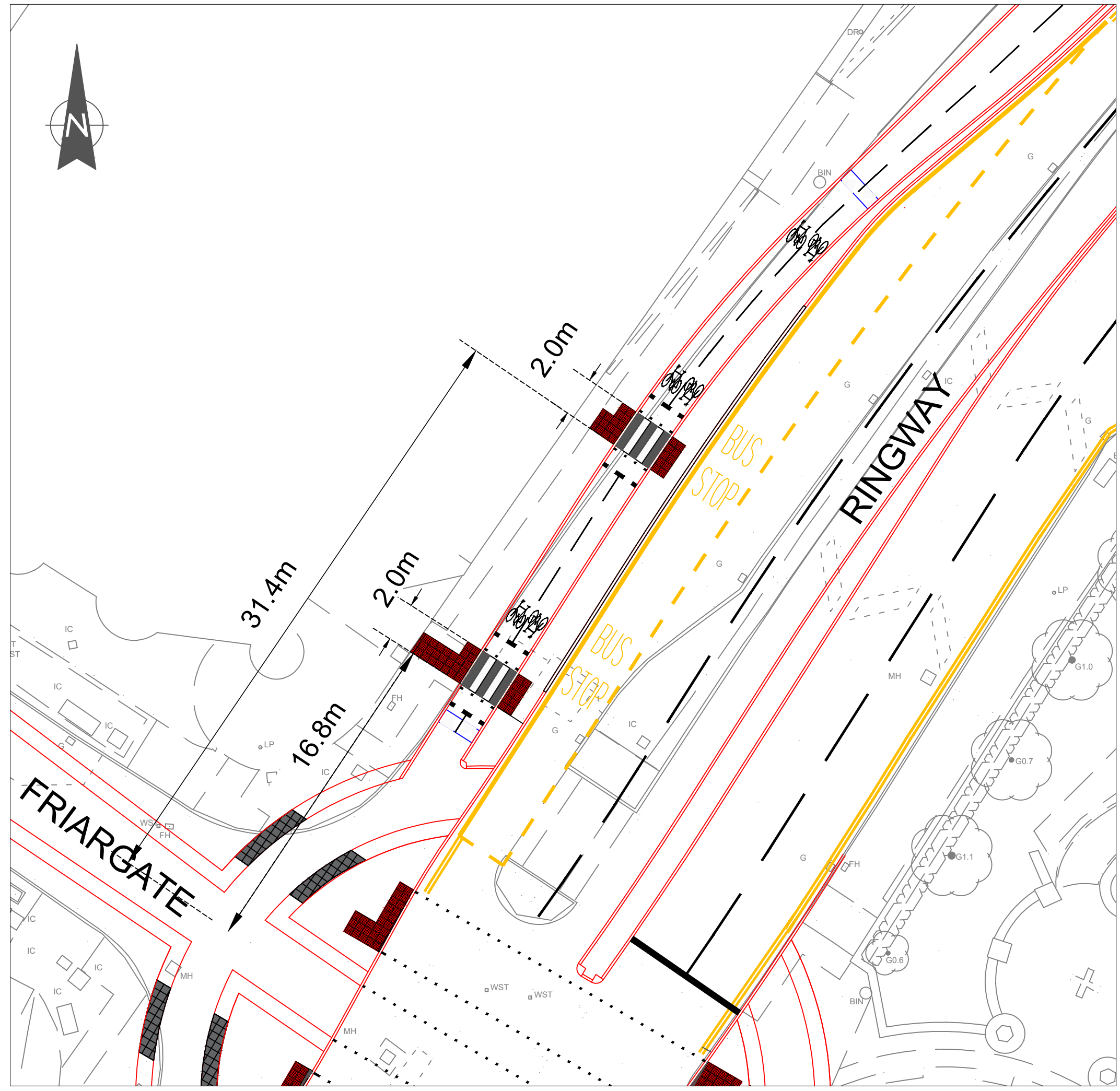

| No. | DATE | AMENDMENT DETAILS | CHECKED BY | DRAWN BY |
|----------------------------|----------|---|--------------|----------------------|
| REVISIONS | | | | |
| | | Design and Construction | | |
| SCALE BAR (PLOTTED mm) | | | | |
| PROJECT TITLE | | TRANSFORMING FRIARGATE NORTH AND RINGWAY | | |
| DRAWING TITLE | | RINGWAY CYCLETRACK CROSSING - TRO PLAN | | |
| DRAWN BY | Z UKADIA | CHECKED BY | - | |
| APPROVED BY | - | DATE | SEPT 2022 | |
| PROJECT No. | 10950 | DRAWING No. | 10950-130-01 | |
| SCALE @ A3 | 1:200 | SHEET No. | 1 of 1. | REVISION 1 |
| CLIENT No. | 10950 | ISSUE PURPOSE CONSULTATION | | |