

Continues on Sheet 1

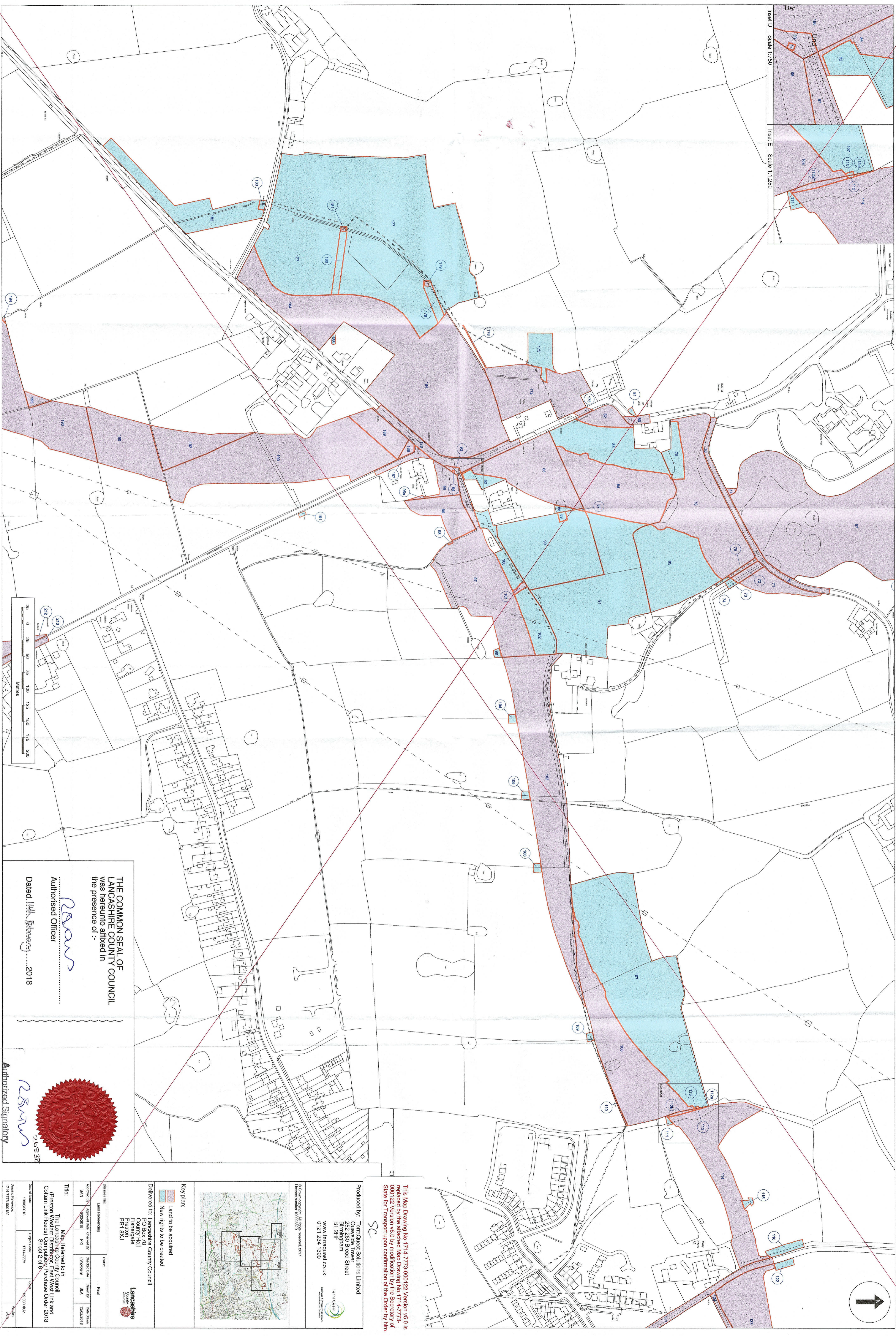

Continues on Sheet 4

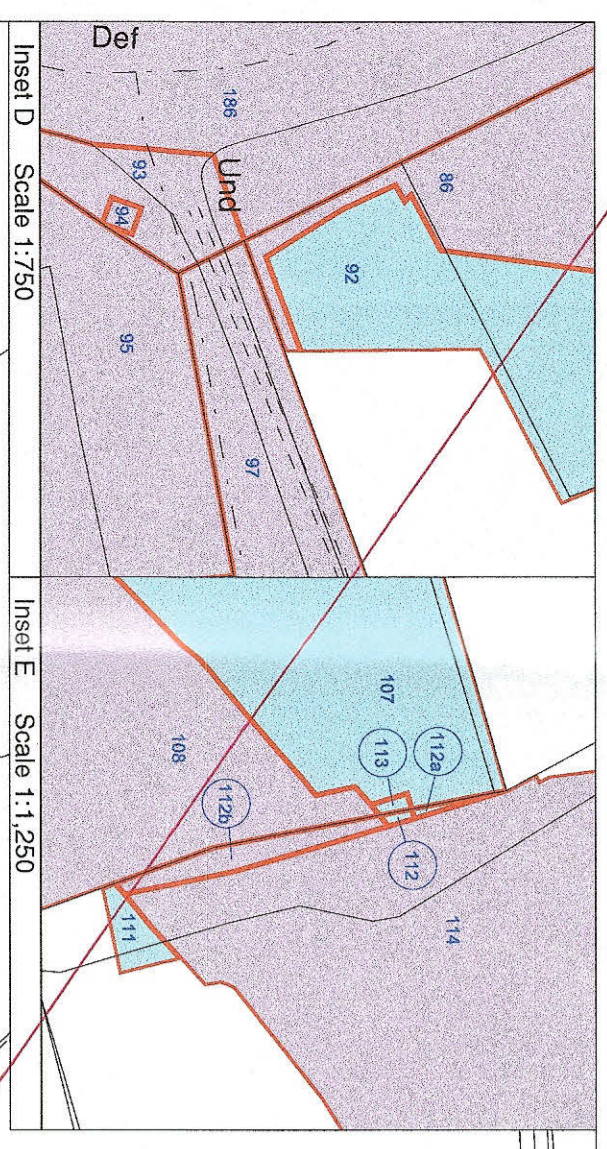
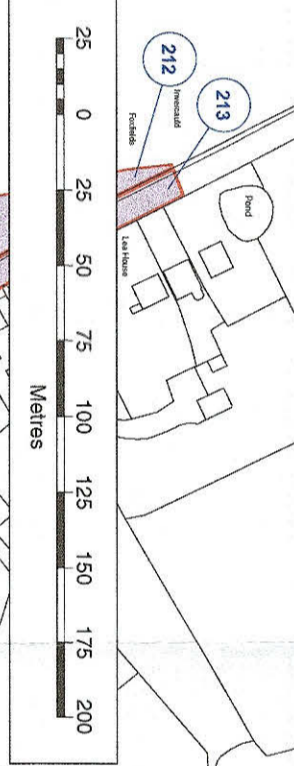

THE COMMON SEAL OF  
LANCASHIRE COUNTY COUNCIL  
was hereunto affixed in  
the presence of:-

*[Signature]*  
Authorised Officer  
Dated 14th February 2018



*[Signature]*  
Authorised Signatory

**Produced by:** Terrapoint Solutions Limited  
Queenside Tower  
252-260 Broad Street  
Birmingham  
B1 2TH  
www.terrarequest.co.uk  
0121 234 1300

**Delivered to:** Lancashire County Council  
PO Box 72  
Fishergate  
Preston  
PR1 8XU

**Key plan:**  
Land to be acquired  
New rights to be created

**© Crown copyright. All rights reserved. 2017  
License number: 10002620**

Drawn by:	13/02/2018	17:14:773	12:00	8A1
Checked by:	14/02/2018	17:14:773	12:00	8A1
Approved by:	14/02/2018	17:14:773	12:00	8A1

**Title:** Map Referred to in The Lancashire County Council (Preston Western Distributor, East West Link and Cottam Link Roads) Compulsory Purchase Order 2018  
Sheet 2 of 6